

To be a world-class leader in cabling industry

- **To customers**
Promise value-added quality and service
- **To business partners**
Make a win-win provision
- **To the earth**
Reduce, recycle, reuse

Index

SOLUTIONS	P.01-03
FIELD TERMINATION PLUG	P.04-12
RJ45 KEYSTONE JACK	P.13-26
NETWORK ADAPTER	P.27-29
PRE-TERMINATED CABLE	P.30-35
RJ45 PATCH CORD	P.36-44
PATCH PANEL	P.45-51
LAN CABLE	P.52-58

Thailand
Factory

China
Factory

Cat.8 S/FTP End to End Solution

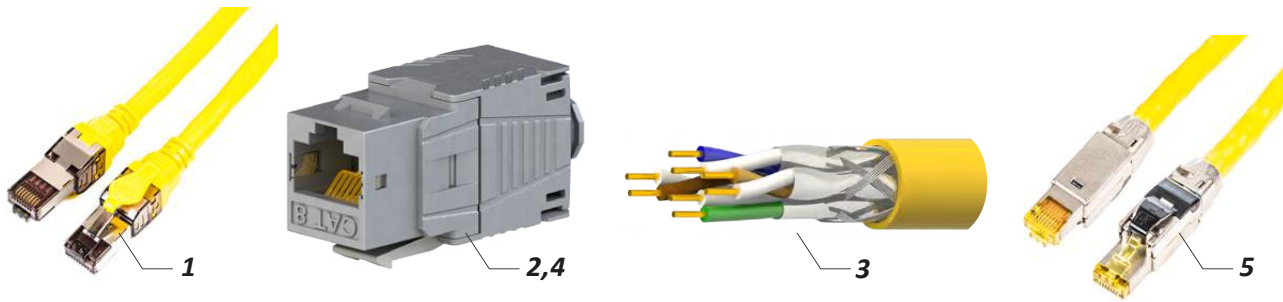

Features

- GHMT verified ISO/IEC 11801-1:2017 class I 2000MHz performance
- Complied with the IEEE802.3bt type4 PoE++ 100 W applications
- Design to support the rate up to 40Gbps and 25Gbps over length up to 30meters

Cat.8 Channel Configuration

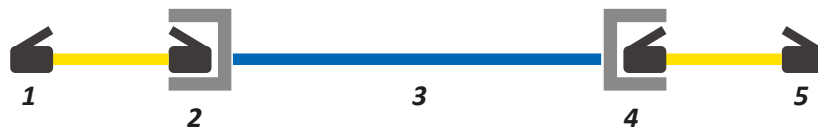

ID	Part Number	Descriptions	Page
1	LW-CA8S24-XXX/YL	Cat.8 S/FTP 24 AWG PCB patch cord, 1 to 5m	P36
2,4	LW-KJW8-C8	180° Cat.8 STP keystone jack, Tool-Free, GHMT and FORCE Verified	P13
3	LW-CA8S22-XXX/YL	Cat.8 horizontal cable, Cat.8 S/FTP 22 AWG solid wires, max. 24m	P52
5	LW-PTC8S-XXX/YL	Cat.8 S/FTP 22 AWG field termination plug patch cord, 1 to 5m	P30

Electrical Characteristics (ISO/IEC 11801-1 Class I)

DC loop resistance	Max. 6.4Ω/30m at 20°C
DC resistance unbalance	Conductor to conductor within a pair, max. 3%
DC resistance unbalance pair to pair	Max. 7%
DC current carrying capacity	0.75 A for each conductor within a single pair, up to 60°C
Dielectric withstand	1000 Vdc, conductor-to-conductor and conductor-to-screen
Propagation delay	Max. 165ns/30m at 2000MHz
Delay skew	Max. 16ns/30m, from 1 to 2000MHz
Coupling attenuation	Environmental Class E1, Max. 50dB from 30 to 100MHz, 24dB at 2000MHz
PoE	60 Vdc, 4PPoE 100 W, IEEE802.3bt type 4

Transmission Performance (ISO/IEC 11801-1 Class I)

Frequency	Return loss	Insertion loss	NEXT	PSNEXT	ACRF	PSACRF	TCL
MHz	Min. dB	Max. dB	Min. dB	Min. dB	Min. dB	Min. dB	Min. dB
1	19.0	3.0	65.0	62.0	65.0	62.0	30.0
100	16.0	6.5	40.5	37.5	32.0	29.0	16.0
250	13.4	10.4	33.6	30.6	24.0	21.0	9.2
500	10.7	15.0	28.4	25.4	18.0	15.0	4.1
600	10.0	16.5	26.2	23.2	16.4	13.4	3.0
1000	8.0	22.0	19.6	16.6	12.0	9.0	3.0
2000	6.2	32.7	9.6	6.6	6.0	3.0	3.0

Cat.6_A STP End to End Solution



Features

- Compliant with ISO/IEC11801-1 class EA and ANSI/TIA 568.2-D Cat.6A 4-conductor channel included the Alien Cross Talk
- Power over HDBaseT™ (PoH) applications up to 100 W

Cat.6_A STP Channel Configuration



ID	Part Number	Descriptions
1	LW-PC6AS-XXX/XX	Cat.6A S/FTP 26 AWG Component-Rated patch cord, molded short boot
2	LW-SMB2P-6AS	Cat.6A STP surface mount box, 2-port
3	LW-PC6AS-XXX/XX	Cat.6A S/FTP 26 AWG Component-Rated patch cord, assembly boot
4	LW-KM88F-C6A	180° Cat.6A STP Connecting-Hardware keystone jack, Tool-free
	LW-KPP48S-1U	STP keystone panel, 1U-48port
5	LW-NPC6AS-XXX	Cat.6A S/FTP or F/UTP 23 AWG solid wires cable
6	LW-KM88F-C6A-D	180° Cat.6A STP Connecting-Hardware keystone jack, Tool-Free, Dust-Cap
	LW-FP300-V6/WH	Faceplate
7	LW-NPC6AF-XXX/XX	Cat.6A F/UTP 26 AWG Component-Rated patch cord, assembly boot
8	LW-NPP24S-C6AD	90° Cat.6A STP patch panel, 1U-24port, Dust-Cap type
9	LW-NPC6AF-XXX/XX	Cat.6A F/UTP 26 AWG Component-Rated patch cord, assembly boot

Electrical Characteristics (ISO/IEC 11801-1 Class EA)

DC loop resistance	Max. 25Ω/100m at 20°C
DC resistance unbalance	Conductor to conductor within a pair, max. 3%
DC resistance unbalance pair to pair	Max. 7%
DC current carrying capacity	0.75 A for each conductor within a single pair, up to 60°C
Dielectric withstand	1000 Vdc, conductor-to-conductor and conductor-to-screen
Propagation delay	Max. 546ns/100m at 500MHz
Delay skew	Max. 50ns/100m, from 1 to 500MHz
Coupling attenuation	Environmental Class E1, Max. 40dB from 30 to 100MHz, 26dB at 500MHz
PoE	60 Vdc, 4PPoE 100 W, IEEE802.3bt type 4

Transmission Performance (ISO/IEC11801-1 Class EA)

Frequency	Return loss	Insertion loss	NEXT	PSNEXT	ACRF	PSACRF	TCL	PSANEXT	PSAACRF
MHz	Min. dB	Max. dB	Min. dB	Min. dB	Min. dB	Min. dB	Min. dB	Min. dB	Min. dB
1	19.0	4.0	65.0	62.0	63.3	60.3	-	-	-
100	12.0	20.9	39.9	37.1	23.3	20.3	-	-	-
250	8.0	33.9	33.1	30.2	15.3	12.3	-	-	-
500	6.0	49.3	27.9	24.8	9.3	6.3	-	-	-

Cat.6A UTP End to End Solution

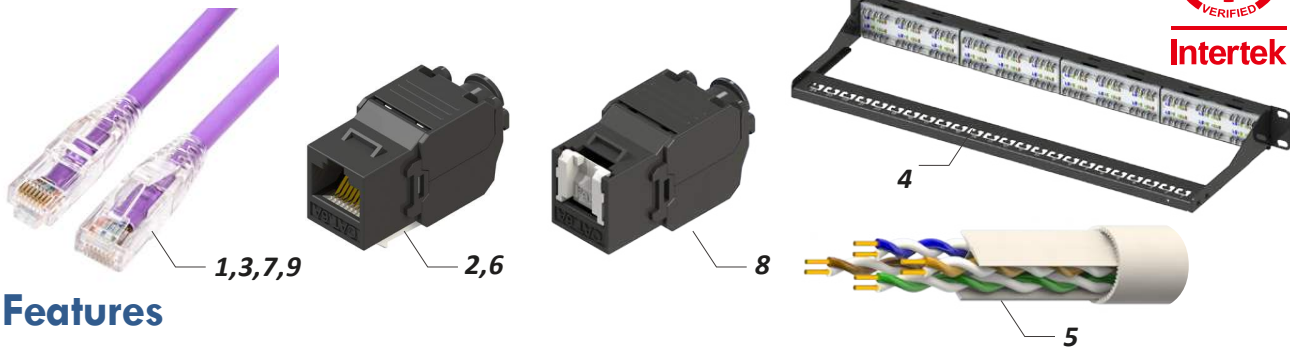

Features

- Extreme performance design for Hyper-Scale and Edge Data Center
- ETL verified ISO/IEC11801-1 class EA and ANSI/TIA 568.2-D Cat.6A 4-conductor channel including the Alien Cross Talk
- Power over HDBaseT™ (PoH) applications up to 100 W

Cat.6A UTP Channel Configuration



ID	Part Number	Descriptions
1	LW-NPC6AU-XXX/XX	Cat.6A UTP 26 AWG Component-Rated patch cord, assembly boot
2	LW-KM88U-C6A	90°Cat.6A UTP Connecting-Hardware keystone jack, Punch-Down
	LW-KPP24U-BK	180°Cat.6A UTP keystone panel, 1U 24-port, deeper support bar
3	LW-NPC6AU-XXX/XX	Cat.6A UTP 26 AWG Component-Rated patch cord, assembly boot
4	LW-NPP24U-C6A	180°Cat.6A UTP Connecting-Hardware patch panel, 1U-24port
5	LW-CA6AU-500/XX	Cat.6A U/UTP 23 AWG solid wires cable
6	LW-KM88U-C6A	90°Cat.6A UTP Connecting-Hardware keystone jack, Punch-Down
	LW-FP300-V6/WH	Faceplate
7	LW-NPC6AU-XXX/XX	Cat.6A UTP 26 AWG Component-Rated patch cord, assembly boot
8	LW-KM88U-C6A-D	180°Cat.6A UTP Connecting-Hardware keystone jack, Tool-Free, Dust-Cap
	LW-KB301A-WH	keystone jack box, with jack bracket, 1-port, white color
9	LW-NPC6AU-XXX/XX	Cat.6A UTP 26 AWG Component-Rated patch cord, assembly boot

Electrical Characteristics (ANSI/TIA-568.2-D)

DC loop resistance	Max. 25Ω/100m at 20°C, 40°C & 60°C
DC resistance unbalance pair-pair	Max. 3%
PoE	60 Vdc, 4PPoE 100 W, IEEE802.3bt type 4
Propagation delay	Max. 546ns/100m at 500MHz
Delay skew	Max. 50ns/100m, from 1 to 500MHz

Transmission Performance (ANSI/TIA-568.2-D)

Frequency	Return loss	Insertion loss	NEXT	PSNEXT	ACRF	PSACRF	TCL	PSANEXT	PSAACRF
MHz	Min. dB	Max. dB	Min. dB	Min. dB	Min. dB	Min. dB	Min. dB	Min. dB	Min. dB
1	19.0	2.3	65.0	62.0	63.3	60.3	40.0	67.0	67.0
4	19.0	4.2	63.0	60.5	51.2	48.2	40.0	67.0	65.0
100	12.0	20.9	39.9	37.1	23.3	20.3	20.0	60.0	37.0
250	8.0	33.9	33.1	30.2	15.3	12.3	14.0	54.0	29.0
500	6.0	49.3	26.1	23.2	9.3	6.3	9.5	49.5	23.0

STP Field Termination Plug, Screw-in Boot Type, Tool-Free



Features

- High-Density and extreme performance by PCB compensation design for Hyper-Scale and Edge Data Center
- Screw-in boot and Tool-Free structure design support easy and quick in-field termination, T568A & B wiring
- Power over HDBaseT™ (PoH) applications up to 100 W
- IP20 performance by the Dust-Cap and Screw-in type boot design
- UL 1863 verified

Standards Compliance

- ANSI/TIA-568.2-D
- ISO/IEC 11801-1, Class EA/Class I
- IEC 60603-7-1
- IEC 60512-99-002
- IEEE 802.3bt Type 4 PoE++ (4PPoE) 100 W
- ANSI/TIA-1096-A (formerly FCC Part 68)
- UL1863
- RoHS/REACH compliant

Part Number Descriptions

LW-FTPS-C6A	Cat.6A STP Field Termination Plug, Screw-in Type Boot, 23-26 AWG
LW-FTPS-C7	Cat.8 STP Field Termination Plug, Screw-in Type Boot, 22-24 AWG
LW-FTPS-C8	Cat.8 STP Field Termination Plug, Screw-in Type Boot, 22-24 AWG

Dimensions (mm)

Tolerance: ± 0.3 mm

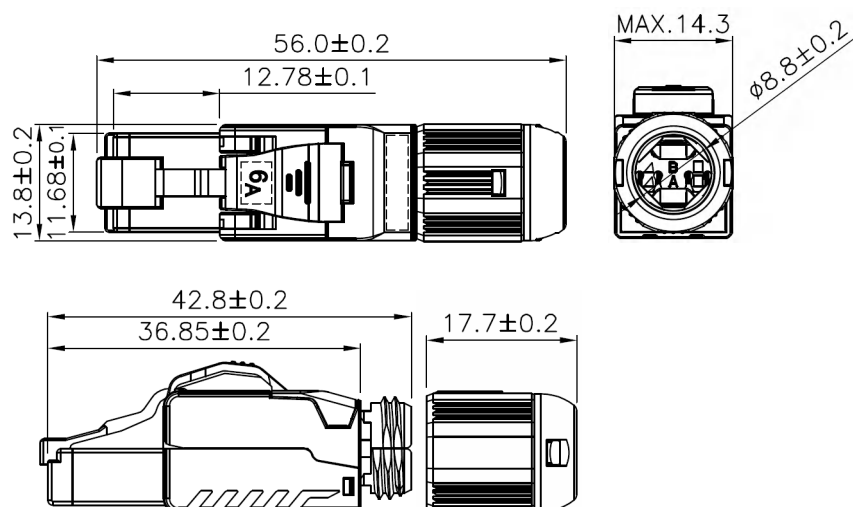

Easy Crimping Tool
P/N: LW-ECT-B

STP Field Termination Plug, Tool-Free Push-Rotate Boot Type

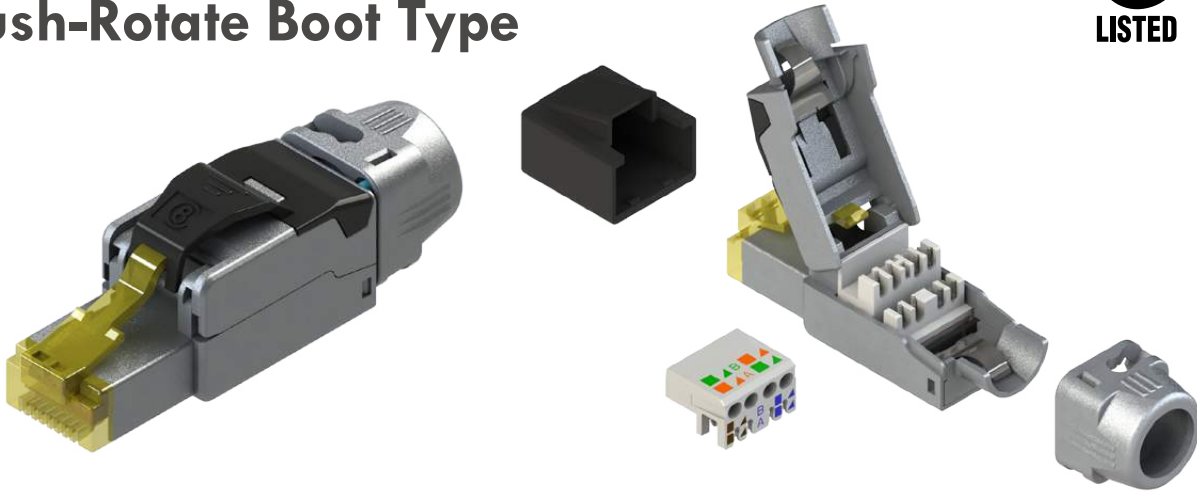

Features

- High-Density and extreme performance by PCB compensation design for Hyper-Scale and Edge Data Center
- Push- Rotate boot and Tool-Free structure design support easy and quick in-field termination, T568A & B wiring
- Power over HDBaseT™ (PoH) applications up to 100 W
- IP20 performance by the Dust-Cap and Push-Rotate boot design
- UL 1863 verified

Standards Compliance

- ANSI/TIA-568.2-D
- ISO/IEC 11801-1, Class EA/Class I
- IEC 60603-7-1
- IEC 60512-99-002
- IEEE 802.3bt Type 4 PoE++ (4PPoE) 100 W
- ANSI/TIA-1096-A (formerly FCC Part 68)
- UL1863
- RoHS/REACH compliant

Part Number Descriptions

LW-FTPR-C6A	Cat.6A STP Field Termination Plug, Push-Rotate Boot, 23-26 AWG
LW-FTPR-C8	Cat.8 STP Field Termination Plug, Push-Rotate Boot, 22-24 AWG

Packing Information

- 1 plug, 1 boot, 1 copper foil and 1 Dust-Cap per bag
- 50 bags per box
- 10 boxes per carton (500 pcs/carton)
- Net weight 12.4 kgs per carton
- Gross weight 14.8 kgs per carton
- Carton size L48.0 x W39.0 x H25.3cm, 1.67 CUFT, 0.047CBM

Dimensions (mm)

Tolerance: ±0.3 mm

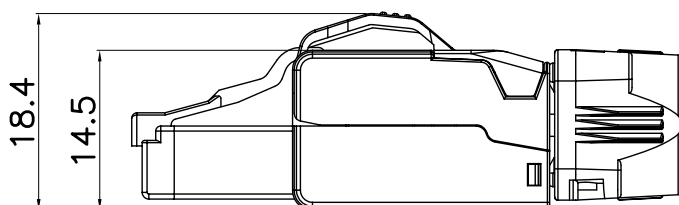
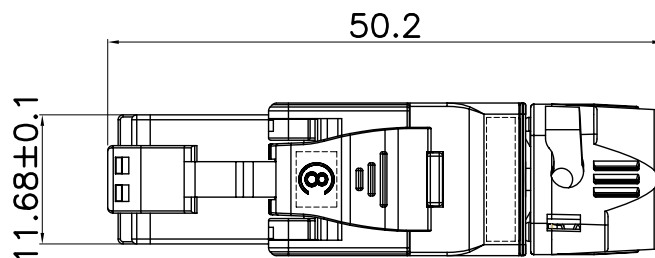
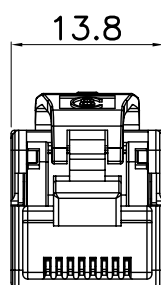

STP Field Termination Plug, Screw-in Boot, Angled Type

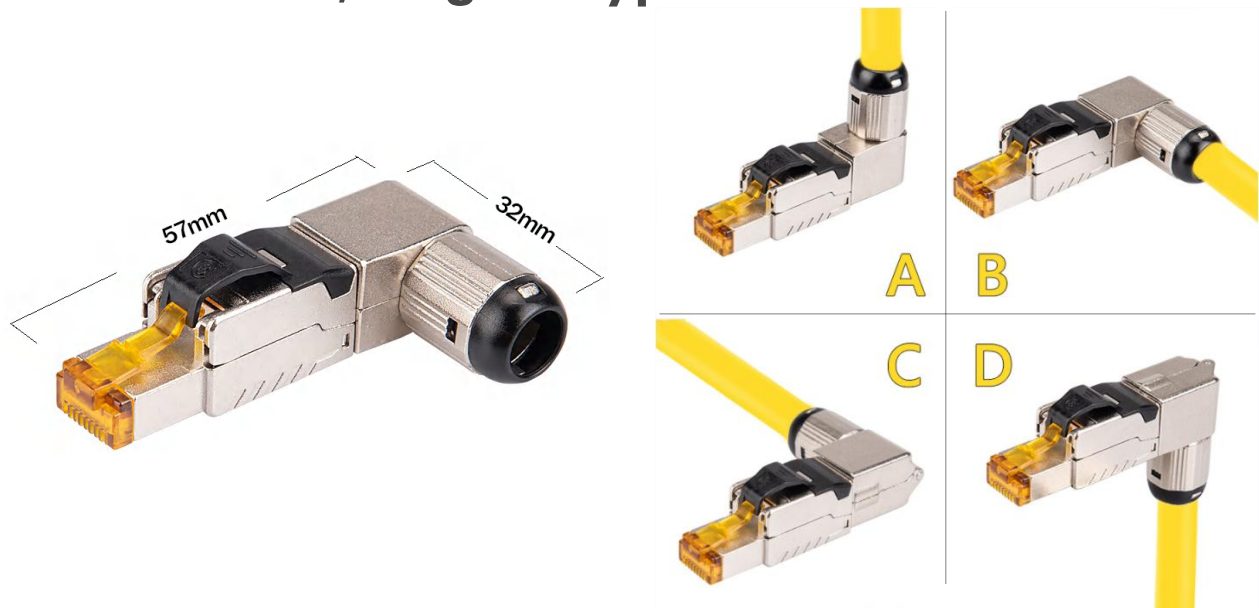

Features

- 5-direction cable entry design
- GHMT verified CAT8 channel class I performance
- GHMT verified IEC60512-99-002 PoE type III 60W and IV 100W capability
- IEEE802.3bt type III and IV application
- CAT8 design to support Ethernet at rates up to 40 Gbps (40GBASE-T) and 25Gbps(25GBASE-T) over distances up to 30 meters for switch-to-server connections in data center
- Power over HDBaseT (PoHDBaseT - up to 100W) application
- High quality connectors ensure system reliability and stability by press-fit assembly process
- CAT6A patch cord component-rated
- IEC60603-7 dimensions and structural reliability complied
- IP20 protection by dust-cap and screw-in boot design

Applications

Wire Gauge (AWG)	Wire O.D. (mm)	Cable O.D. (mm)
26/7 – 23/1	1.0 - 1.45	6.0 - 7.5
24/7 – 22/1	1.2 - 1.65	7.0 - 8.5

Part No.	Description
LW-FTPA-C6A	CAT6A field connector, full shielded, 5-directions angled, screw-in boot type, toolless
LW-FTPA-C7	CAT7 field connector, full shielded, 5-directions angled, screw-in boot type, toolless
LW-FTPA-C8	CAT8 field connector, full shielded, 5-directions angled, screw-in boot type, toolless

Easy Crimping Tool

LW-ECT-B



STP Field Termination Plug, Linkwylan P117 Tool-Free



Features

- High-Density and extreme performance by PCB compensation design for Hyper-Scale and Edge Data Center
- Metal screw boot and Tool-Free structure design support easy and quick in-field termination, T568A & B wiring
- Power over HDBaseT™ (PoH) applications up to 100 W
- IP20 performance by the Dust-Cap and Metal screw-in boot design

Standards Compliance

- ANSI/TIA-568.2-D
- ISO/IEC 11801-1, Class E/Class EA
- IEC 60603-7-1, IEC 60512-99-002
- IEEE 802.3bt Type 4 PoE++ (4PPoE) 100 W
- ANSI/TIA-1096-A (formerly FCC Part 68)
- RoHS/REACH compliant

Part Number Descriptions

Part Number	Descriptions
LW-P117-C6S	Cat.6 STP Field Termination Plug, Push-Rotate Boot, 23-26 AWG
LW-P117-C6AS	Cat.6A STP Field Termination Plug, Push-Rotate Boot, 23-26 AWG
LW-P117-C7S	Cat.7 STP Field Termination Plug, Push-Rotate Boot, 23-26 AWG

Dimensions (mm)

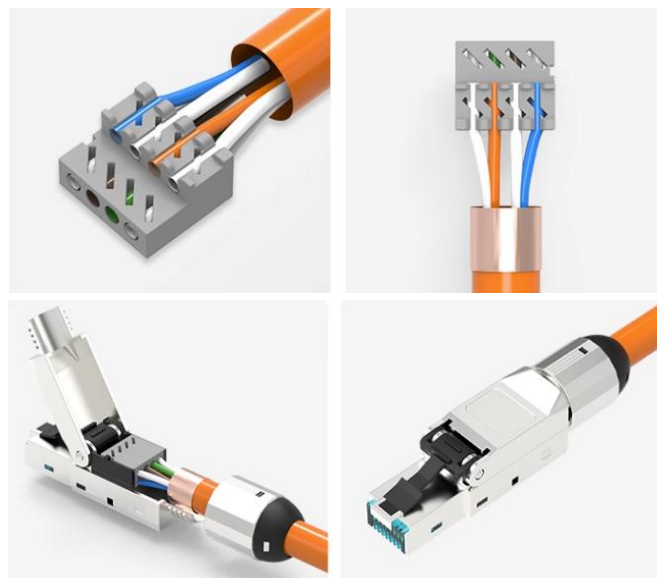
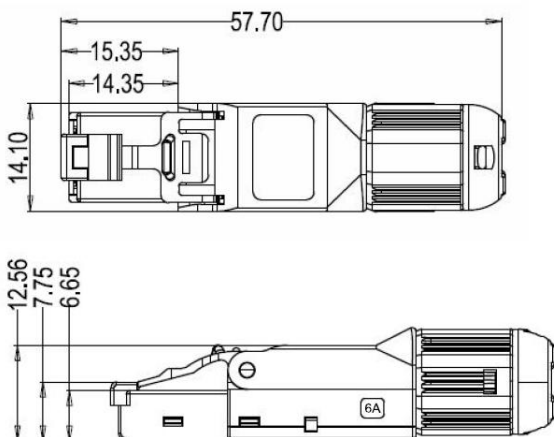

STP Field Termination Plug, Linkwylan FP168 Toolless

★ **PATENTED** ★

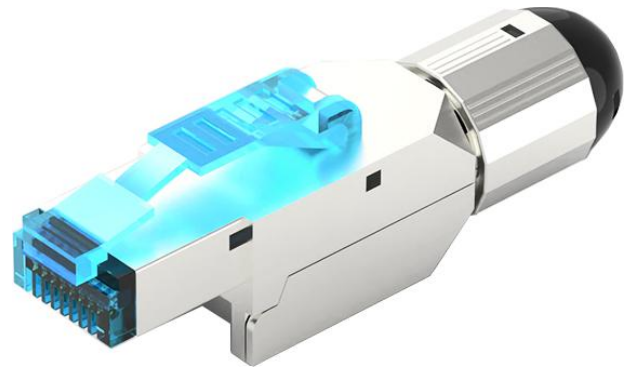

Features

- High-Density and extreme performance by PCB compensation design for Hyper-Scale and Edge Data Center
- Screw-in boot and Tool-Free structure design support easy and quick in-field termination, T568A & B wiring
- Power over HDBaseT™ (PoH) applications up to 100 W
- IP20 performance by the Dust-Cap and Screw-in type boot design

Standards Compliance

- ANSI/TIA-568.2-D
- ISO/IEC 11801-1, Class EA/Class I
- IEC 60603-7-1
- IEC 60512-99-002
- IEEE 802.3bt Type 4 PoE++ (4PPoE) 100 W
- ANSI/TIA-1096-A (formerly FCC Part 68)
- CAT 8 Class I Channel Verified
- RoHS/REACH compliant

Part Number Descriptions

LW-FP168-C8 Cat.8 STP Field Termination Plug, Screw-in Type Boot, 22-24 AWG

Fast Installation Guide

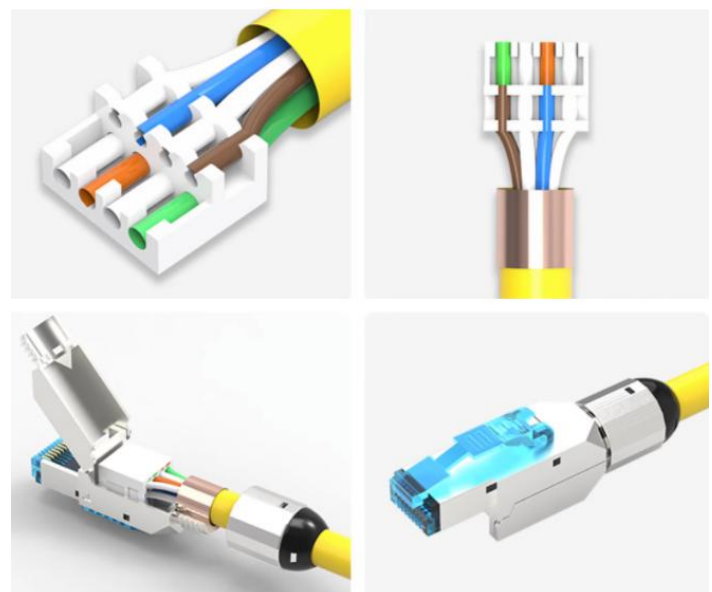
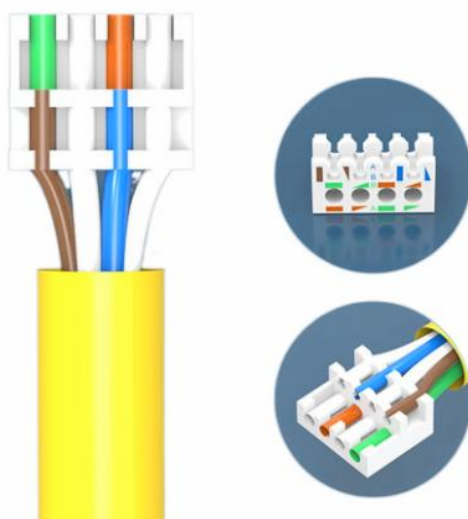

STP/UTP Field Termination Plug, Linkwylan P118 Toolless

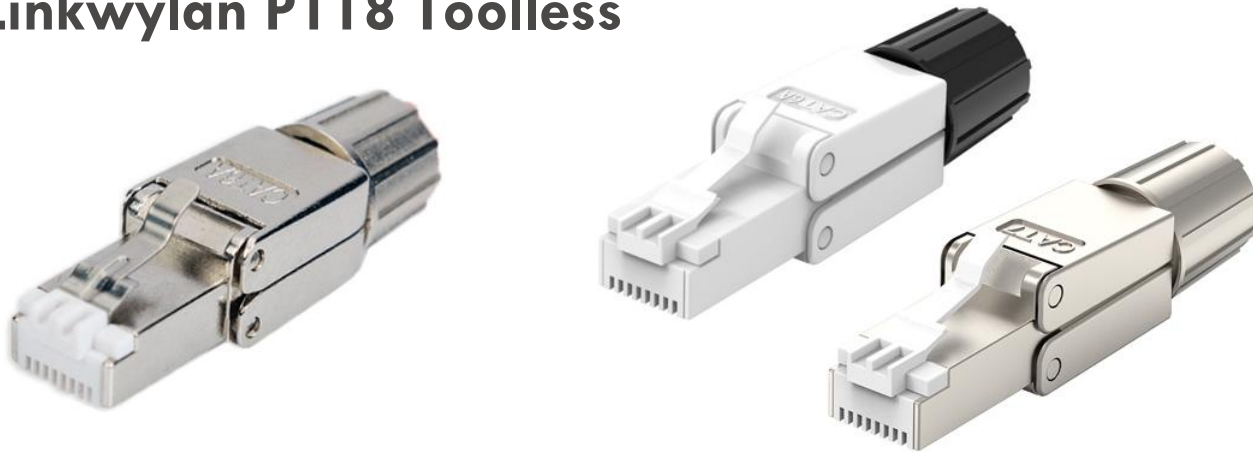

Features

- High-Density and extreme performance by PCB compensation design for Hyper-Scale and Edge Data Center
- Metal screw boot and Tool-Free structure design support easy and quick in-field termination, T568A & B wiring
- Power over HDBaseT™ (PoH) applications up to 100 W
- High quality connectors ensure system reliability and stability by press-fit assembly process

Standards Compliance

- ANSI/TIA-568.2-D
- ISO/IEC 11801-1, Class E/Class EA
- IEC 60603-7-1, IEC 60512-99-002
- IEEE 802.3bt Type 4 PoE++ (4PPoE) 100 W
- ANSI/TIA-1096-A (formerly FCC Part 68)
- RoHS/REACH compliant

Part Number Descriptions

LW-P118-C6AU	Cat.6A UTP Field Termination Plug, Plastic Screw-in Boot, 23-26 AWG
LW-P118-C6AS	Cat.6A STP Field Termination Plug, Metal Screw-in Boot, 23-26 AWG
LW-P118-C7S	Cat.7 STP Field Termination Plug, Metal Screw-in Boot, 22-24 AWG

Dimensions (mm)

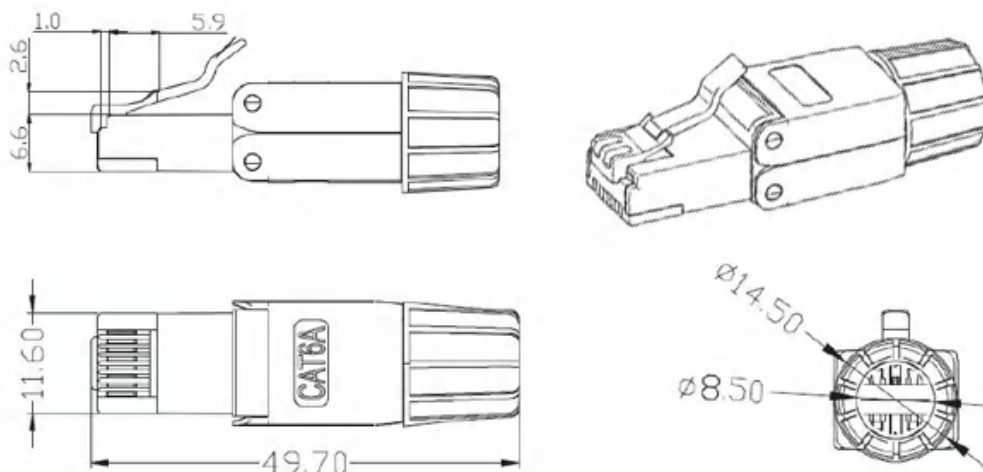

UTP Field Termination Plug, Linkwylan P118 Toolless



Features

- Extreme performance by PCB compensation design for Hyper-Scale and Edge Data Center
- Easy field termination, T568A & B wiring
- Power over HDBaseT™ (PoH) applications up to 100 W
- Design to support Ethernet at rates up to 1 Gbps over distances up to 55 meters
- Up to 90 meters Modular Plug Terminated Link (MPTL) applications
- Design to support CAT6 patch cord channel performance

Standards Compliance

- ANSI/TIA-568.2-D
- ISO/IEC 11801-1, Class D/E
- IEC 60603-7
- IEC 60512-99-002
- IEEE 802.3bt Type 4 PoE++ (4PPoE) 100 W
- ANSI/TIA-1096-A (formerly FCC Part 68)
- UL 94V-2
- RoHS/REACH compliant

Part Number Descriptions

LW-P118-C5U

Cat.5e UTP Field Termination Plug, Press To Crimp Boot, 23-26 AWG

LW-P118-C6U

Cat.6 UTP Field Termination Plug, Press To Crimp Boot, 23-26 AWG

Dimensions (mm)

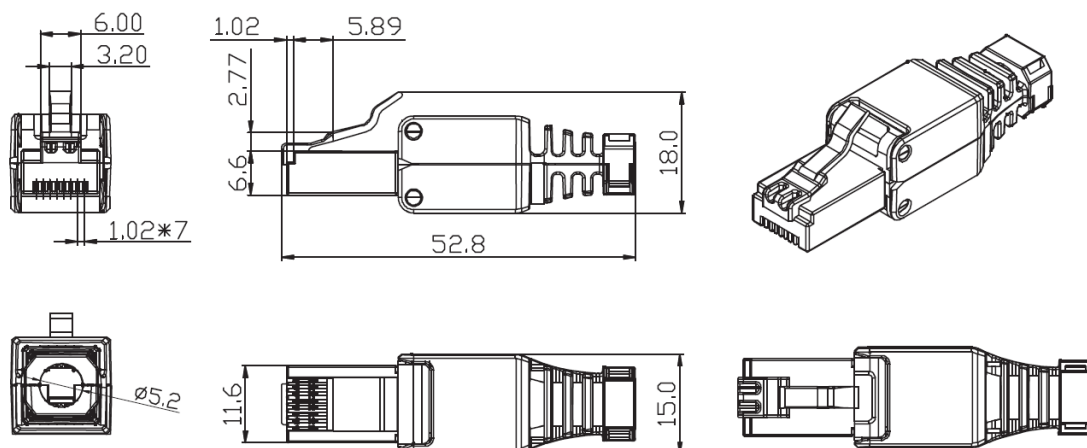

Rotatable UTP Field Termination Plug Linkwylan FPR Tool-Free

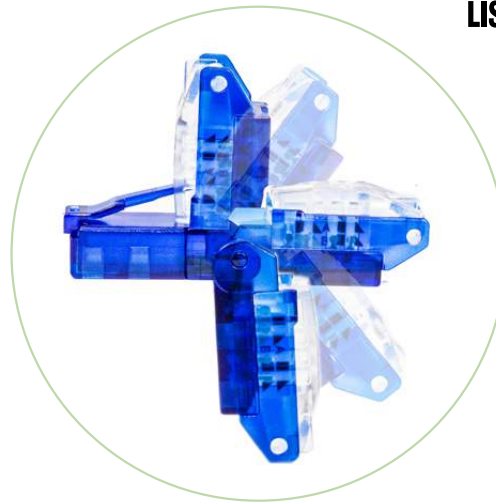

Features

- Rotatable design to fit in the small space
- PCB compensation design, up to 90 meters Modular Plug Terminated Link(MPTL) applications
- Easy field termination, T568A & B wiring
- Power over HDBaseT™ (PoH) applications up to 30 W
- UL 1863 verified

Standards Compliance

- ANSI/TIA-568.2-D
- ISO/IEC 11801-1, Class D/E
- IEC 60603-7
- IEC 60512-99-001
- IEEE 802.3at Type 2 PoE 30 W
- ANSI/TIA-1096-A (formerly FCC Part 68)
- UL1863
- RoHS/REACH compliant

Part Number Descriptions

LW-FPR-C5U/BL	Cat.5E Rotatable UTP Field Termination Plug, blue color
LW-FPR-C6U/BL	Cat.6 Rotatable UTP Field Termination Plug, blue color

Packing Information

- 1 plug per bag
- 50 bags per box
- 10 boxes per carton (500 pcs/carton)
- Net weight 1.8 kgs per carton
- Gross weight 4.3 kgs per carton
- Carton size L48.0 x W39.0 x H25.3cm, 1.67 CUFT, 0.047CBM

Dimensions (mm)

Tolerance: ±0.3 mm

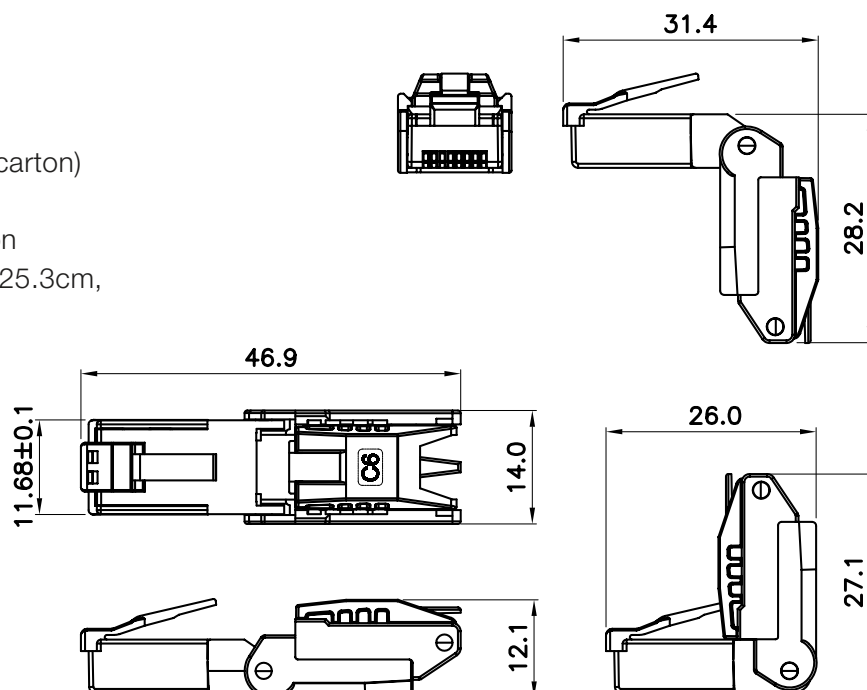

STP Field Termination Plug, Linkwylan P119 Toolless



Features

- High-Density and extreme performance by PCB compensation design for Hyper-Scale and Edge Data Center
- Screw-in boot and Tool-Free structure design support easy and quick in-field termination, T568A & B wiring
- Power over HDBaseT™ (PoH) applications up to 100 W
- Plastic screw-in type boot, blue and black color are available

Standards Compliance

- ANSI/TIA-568.2-D
- ISO/IEC 11801-1, Class EA/Class I
- IEC 60603-7-1
- IEC 60512-99-002
- IEEE 802.3bt Type 4 PoE++ (4PPoE) 100 W
- ANSI/TIA-1096-A (formerly FCC Part 68)
- GHMT CAT 8 Class I Channel Certificated
- RoHS/REACH compliant

Part Number Descriptions

LW-P119-C6A

Cat.6A STP Field Termination Plug, Plastic Screw-in Boot, 23-26 AWG

LW-P119-C8

Cat.8 STP Field Termination Plug, Plastic Screw-in Boot, 22-24 AWG

Fast Installation Guide

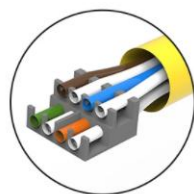

180° STP Keystone Jack, Tool-Free GHMT and FORCE Verified

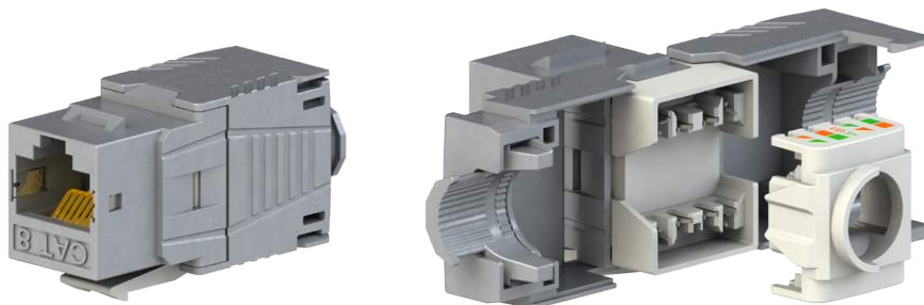

Features

- High-Density design for 1U-48port keystone panel, extreme performance design for Hyper-Scale and Edge Data Center
- GHMT verified ISO/IEC 11801-1 C6A Connecting-Hardware and ISO/IEC 11801-1 Class I 2000MHz for Cat.8 version
- FORCE Technology Verified ISO/IEC 11801-1 and IEC 60603-7-51 Cat.6A Connecting-Hardware
- The 4PPoE performance tested by GHMT for Cat.6A version
- Easy and Tool-Free in field termination, T568A & B wiring
- Power over HDBaseT™ (PoH) applications up to 100 W
- UL 1863 verified

Standards Compliance

- ANSI/TIA-568.2-D
- ISO/IEC 11801-1
- IEC 60603-7-51
- IEC 60603-7-1
- IEC 60512-99-002
- EEN 50173-1
- IEEE 802.3bt Type 4 PoE++ (4PPoE) 100 W
- ANSI/TIA-1096-A (formerly FCC Part 68)
- UL1863
- RoHS/REACH compliant

Part Number

LW-KJW8-C6A
LW-KJW8-C8

Descriptions

180° Cat.6A STP Keystone Jack, Tool-Free, 23-26 AWG
180° Cat.8 STP Keystone Jack, Tool-Free, 22-24 AWG

Packing Information

- 1 keystone jack, 1 IDC-Cap, 1 copper foil sticker & 1 Cable-Tie per bag
- 50 bags and 1 Installation-Instruction per box
- 10 boxes per carton (500 pcs/carton)
- Net weight 15.7 kgs per carton
- Gross weight 16.7 kgs per carton
- Carton size L48.0 x W39.0 x H25.3cm, 1.67 CUFT, 0.047CBM

Dimensions (mm)

Tolerance: ±0.3 mm

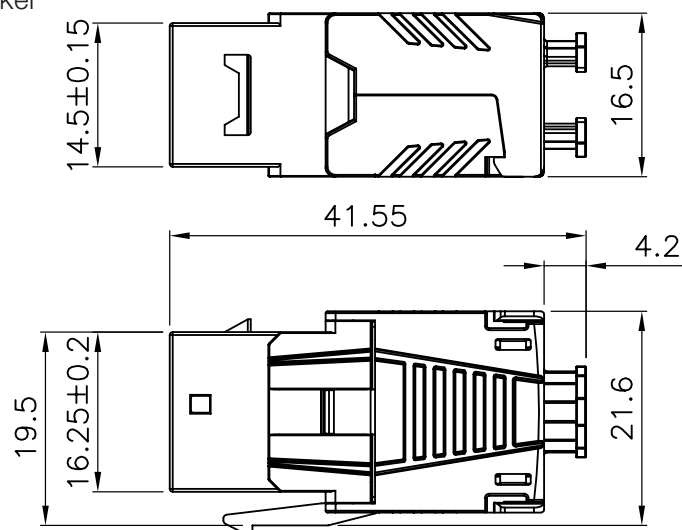
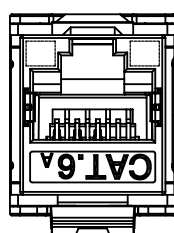

180° STP Connecting-Hardware Keystone Jack, Tool-Free, Cable-Clamper Type, FORCE Technology Verified



★ PATENTED ★

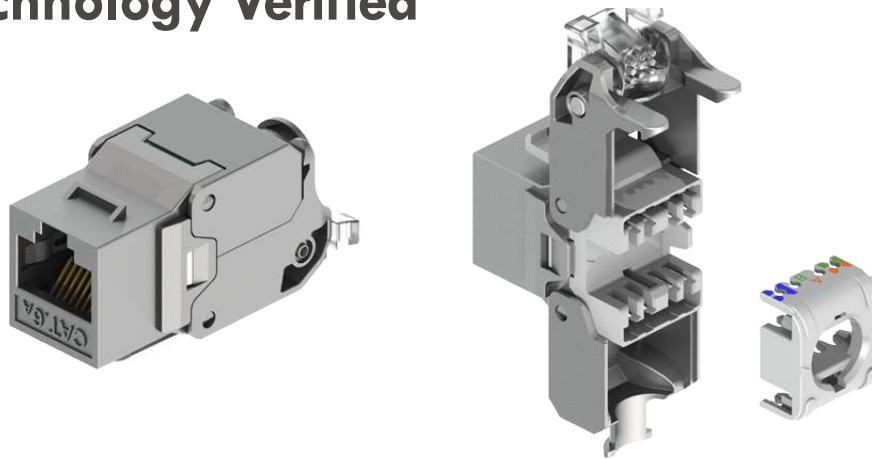

Features

- High-Density design for 1U-24port keystone panel, extreme performance for Edge Data Center
- FORCE Technology Verified ANSI/TIA-568.2-D Connecting-Hardware including the 4PPoE performance
- Quick and efficient installation by Cable-Clamper structure, Fool-Proofing and Pre-Lock design of IDC-cap
- Hi-Pot insulation performance improved by IDC's Housing-Wall design
- 22-26 AWG stranded and solid wires range
- T568A & B wiring
- Power over HDBaseT™ (PoH) applications up to 100 W
- UL 1863 verified

Standards Compliance

- ANSI/TIA-568.2-D
- ISO/IEC 11801-1, Class D/E/EA
- IEC 60603-7-1
- IEC 60512-99-002
- IEEE 802.3bt Type 4 PoE++ (4PPoE) 100 W
- ANSI/TIA-1096-A (formerly FCC Part 68)
- UL1863
- RoHS/REACH compliant

Part Number Descriptions

LW-KM68F-C6	180° Cat.6 STP Connecting-Hardware, Cable-Clamper Type, 23-26 AWG
LW-KM68F-C6A	180° Cat.6A STP Connecting-Hardware, Cable-Clamper Type, 23-26 AWG
LW-KM68F-C6-22	180° Cat.6 STP Connecting-Hardware, Cable-Clamper Type, 22-24 AWG
LW-KM68F-C6A-22	180° Cat.6A STP Connecting-Hardware, Cable-Clamper Type, 22-24 AWG

Packing Information

- 1 keystone jack & 1 IDC-Cap per bag
- 50 bags and 1 Installation-Instruction per box
- 10 boxes per carton (500 pcs/carton)
- Net weight 11.8 kgs per carton
- Gross weight 14.5 kgs per carton
- Carton size L48.0 x W39.0 x H25.3cm, 1.67 CUFT, 0.047CBM

Dimensions (mm)

Tolerance: ±0.3 mm

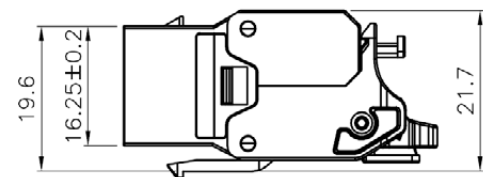
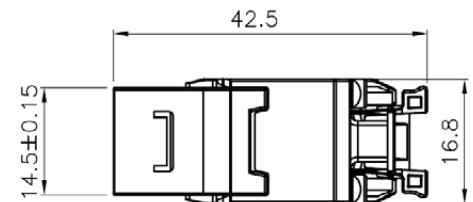

180° STP Connecting-Hardware Keystone Jack, Tool-Free, FORCE Verified

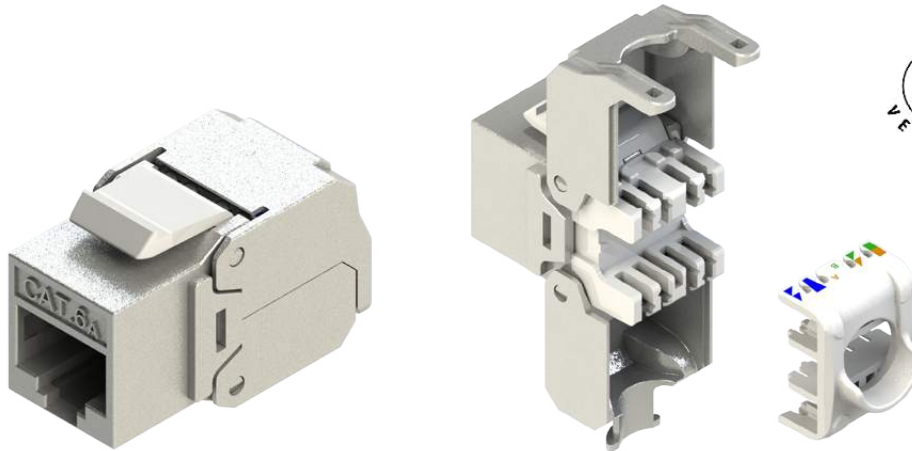

Features

- High-Density design for 1U-24port keystone panel, extreme performance design for Hyper-Scale and Edge Data Center
- FORCE Technology Verified ANSI/TIA-568.2-D Connecting-Hardware including the 4PPoE performance
- Easy and Tool-Free in field termination, T568A & B wiring
- Power over HDBaseT™ (PoH) applications up to 100 W
- UL 1863 verified

Standards Compliance

- ANSI/TIA-568.2-D
- ISO/IEC 11801-1, Class D/E/EA
- IEC 60603-7-1
- IEC 60512-99-002
- IEEE 802.3bt Type 4 PoE++ (4PPoE) 100 W
- ANSI/TIA-1096-A (formerly FCC Part 68)
- UL1863
- RoHS/REACH compliant

Part Number

Descriptions

LW-KM88F-C5E	180° Cat.5E STP Connecting-Hardware Keystone Jack, Tool-Free
LW-KM88F-C6	180° Cat.6 STP Connecting-Hardware Keystone Jack, Tool-Free
LW-KM88F-C6A	180° Cat.6A STP Connecting-Hardware Keystone Jack, Tool-Free

Packing Information

- 1 keystone jack, 1 IDC-Cap & 1 Cable-Tie per bag
- 50 bags and 1 Installation-Instruction per box
- 10 boxes per carton (500 pcs/carton)
- Net weight 11.8 kgs per carton
- Gross weight 14.5 kgs per carton
- Carton size L48.0 x W39.0 x H25.3cm, 1.67 CUFT, 0.047CBM

Dimensions (mm)

Tolerance: ±0.3 mm

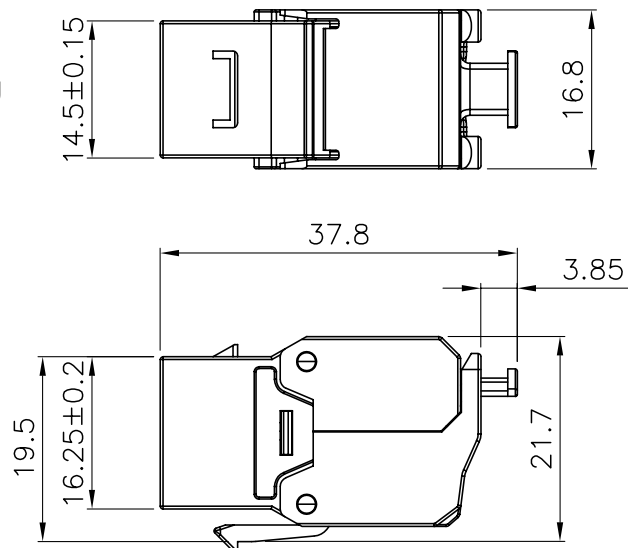
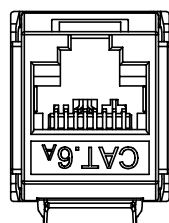

180° STP Connecting-Hardware Keystone Jack, Tool-Free, Dust-Cap Type, FORCE Technology Verified

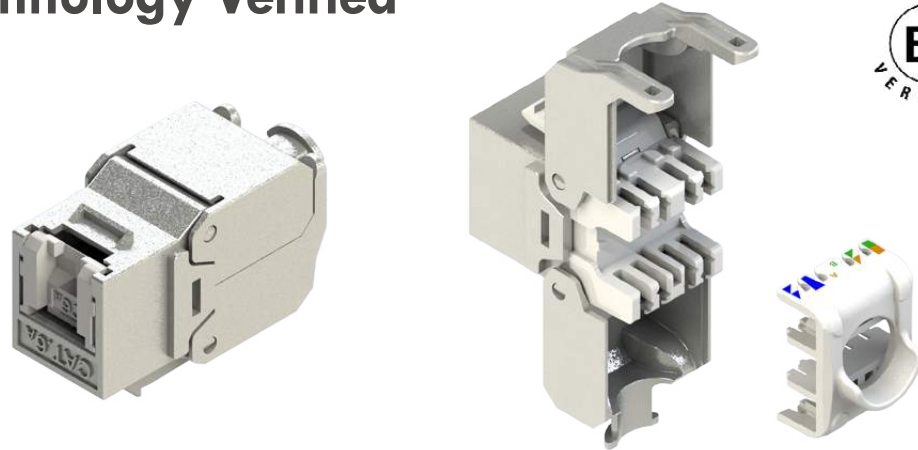

Features

- High-Density design for 1U-24port keystone panel, extreme performance design for Hyper-Scale and Edge Data Center
- FORCE Technology Verified ANSI/TIA-568.2-D Connecting-Hardware including the 4PPoE performance
- Easy and Tool-Free in field termination, T568A & B wiring
- Power over HDBaseT™ (PoH) applications up to 100 W
- UL 1863 verified
- IP20 by Dust-Cap design

Standards Compliance

- ANSI/TIA-568.2-D
- ISO/IEC 11801-1, Class D/E/EA
- IEC 60603-7-1
- IEC 60512-99-002
- IEEE 802.3bt Type 4 PoE++ (4PPoE) 100 W
- ANSI/TIA-1096-A (formerly FCC Part 68)
- UL1863
- RoHS/REACH compliant

Part Number Descriptions

LW-KM88F-C5E-D	180° Cat.5E STP Connecting-Hardware Keystone Jack, Tool-Free, Dust-Cap
LW-KM88F-C6-D	180° Cat.6 STP Connecting-Hardware Keystone Jack, Tool-Free, Dust-Cap
LW-KM88F-C6A-D	180° Cat.6A STP Connecting-Hardware Keystone Jack, Tool-Free, Dust-Cap

Packing Information

- 1 keystone jack, 1 IDC-Cap & 1 Cable-Tie per bag
- 50 bags and 1 Installation-Instruction per box
- 10 boxes per carton (500 pcs/carton)
- Net weight 11.8 kgs per carton
- Gross weight 14.5 kgs per carton
- Carton size L48.0 x W39.0 x H25.3cm, 1.67 CUFT, 0.047CBM

Dimensions (mm)

Tolerance: ±0.3 mm

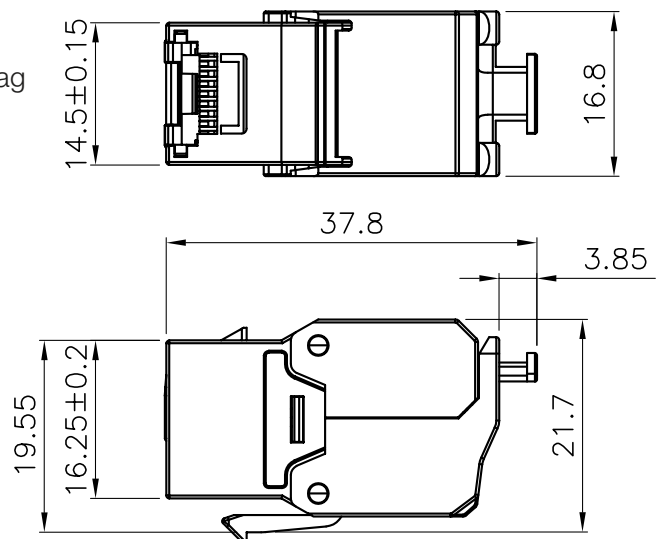
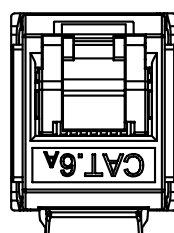

180° Keystone Jack With Multicolor Identification Tool-Free, Full Shielded



PATENTED



Features

- High-Density design for 1U-24port keystone panel, extreme performance design for Hyper-Scale and Edge Data Center
- ETL verified ISO/IEC 11801-1 perm. link test, 4PPoE performance tested
- Easy and Tool-Free in field termination, T568A & B wiring
- Power over HDBaseT™ (PoH) applications up to 100 W
- Colored identifications in front of the jack, multi-colors (8 colors) are available

Standards Compliance

- ANSI/TIA-568.2-D
- ISO/IEC 11801-1, Class D/E/EA
- IEC 60603-7-1
- IEC 60512-99-002
- IEEE 802.3bt Type 4 PoE++ (4PPoE) 100 W
- ANSI/TIA-1096-A (formerly FCC Part 68)
- UL 94V-2
- RoHS/REACH compliant

Part Number

Descriptions

LW-KJ29F-C5E/XX	180° Cat.5E STP Keystone Jack, Tool-Free, Multi-Colors Are Available
LW-KJ29F-C6/XX	180° Cat.6 STP Keystone Jack, Tool-Free, Multi-Colors Are Available
LW-KJ29F-C6A/XX	180° Cat.6A STP Keystone Jack, Tool-Free, Multi-Colors Are Available

Packing Information

- 1 keystone jack, 1 IDC-Cap & 1 Cable-Tie per bag
- 50 bags and per box
- 10 boxes per carton (500 pcs/carton)
- Net weight 12.8 kgs per carton
- Gross weight 14.5 kgs per carton
- Carton size L57 x W35 x H23 cm



180° STP Keystone Jack, Linkwylan KJ169 Tool-Free, Cat.8 40G Class I



Features

- High-Density design for 1U-24port keystone panel, extreme performance design for Hyper-Scale and Edge Data Center
- Perm. Link Tested by Fluke 30M With Linkwylan Cat.8 22AWG S/FTP Installation Cable
- Easy and Tool-Free in field termination, T568A & B wiring
- Power over HDBaseT™ (PoH) applications up to 100 W
- Cat.8 40G 2000MHz Class I

Standards Compliance

- ANSI/TIA-568.2-D
- ISO/IEC 11801-1, Class I
- IEC 60603-7-1
- IEC 60512-99-002
- IEEE 802.3bt Type 4 PoE++ (4PPoE) 100 W
- ANSI/TIA-1096-A (formerly FCC Part 68)
- Cat.8 30m Perm. Link Test Performance
- RoHS/REACH compliant

Part Number Descriptions

LW-KJ169-C8 180° Cat.8 STP Keystone Jack, Tool-Free, Per. Link Test Performance

Dimensions (mm)

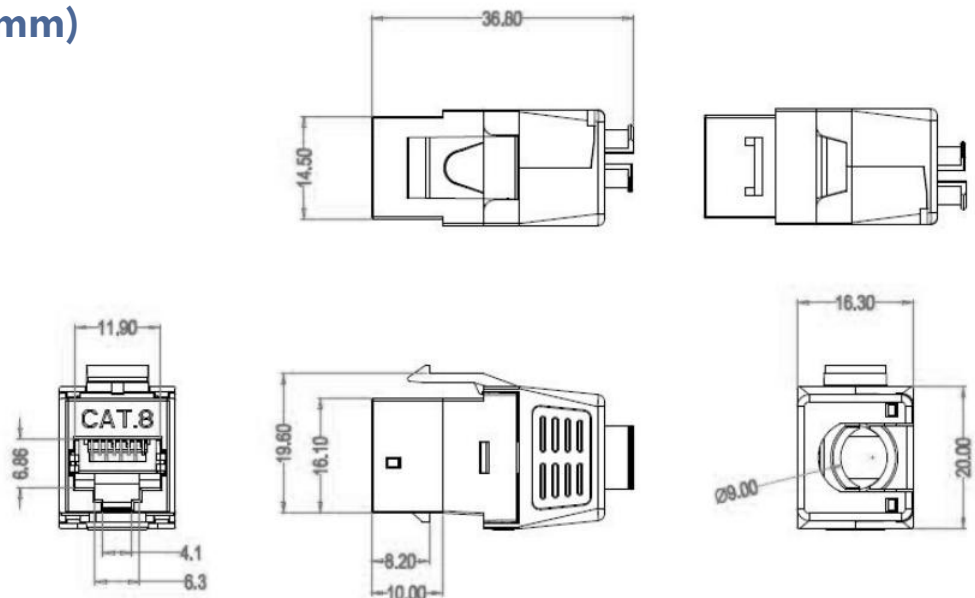

Cat.8 STP Keystone Jack, Tool-Free, GHMT 2-Connector Channel Certificated



Features

- High-Density design for 1U-48port keystone panel, extreme performance design for Hyper-Scale and Edge Data Center
- GHMT verified ISO/IEC 11801-1 Cat 8 40G 2000MHz Class I 2-Connectors Channel
- Fluke Test Perm. Link 30m With Linkwylan Cat 8 Installation Cable
- The 4PPoE performance tested by GHMT
- Easy and Tool-Free in field termination, T568A & B wiring
- Power over HDBaseT™ (PoH) applications up to 100 W

Standards Compliance

- ANSI/TIA-568.2-D
- ISO/IEC 11801-1
- IEC 60603-7-51
- IEC 60603-7-1
- IEC 60512-99-002
- EEN 50173-1
- IEEE 802.3bt Type 4 PoE++ (4PPoE) 100 W
- ANSI/TIA-1096-A (formerly FCC Part 68)
- UL1863
- RoHS/REACH compliant

Part Number

LW-KJ119-C8

Descriptions

180° Cat.8 STP Keystone Jack, Tool-Free, 22-26 AWG

Dimensions (mm)

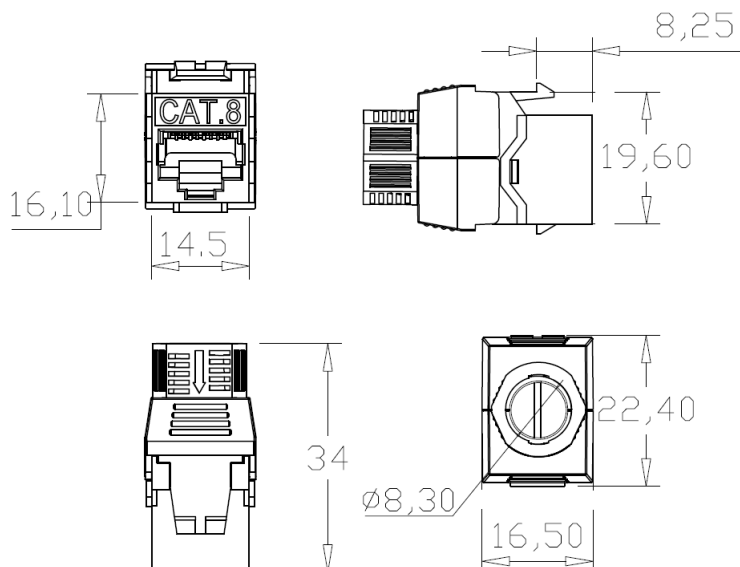
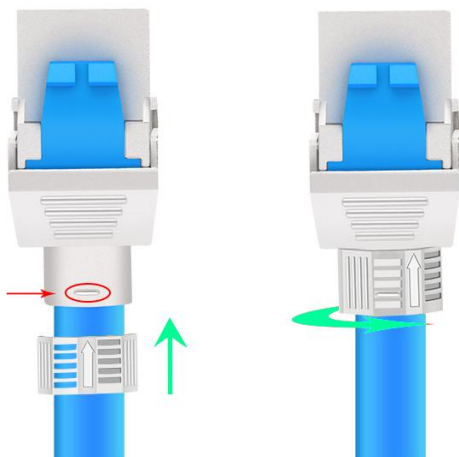

STP Keystone Jack, Tool-Free Cat.7 90 Degree LSA Termination

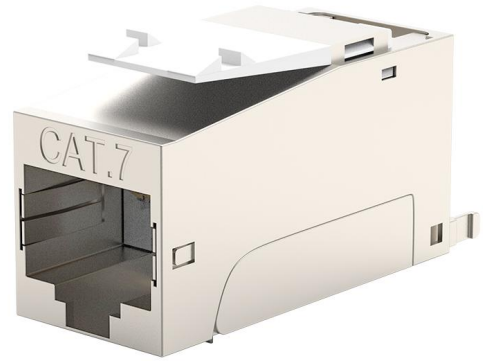
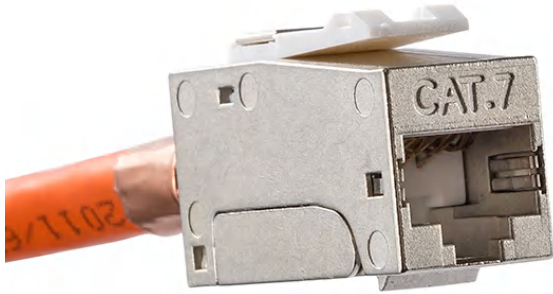

Features

- TIA CAT6A channel performance
- ISO/IEC 11801 Class Ea Perm. Link performance
- IEC60512-99-002 PoE type III 60W and IV 100W capability
- IEEE802.3bt type III and IV application
- Power over HDBaseT (PoHDBaseT - up to 100W)
- Suitable for 22-24 AWG solid&stranded cables, O.D from 6.5-9.0mm
- IEC60603-7 dimensions and structural reliability complied
- Accepts LW 1U 24-Port and 1U 48-Port keystone panel
- L x W x H: 38 x 16 x 21mm

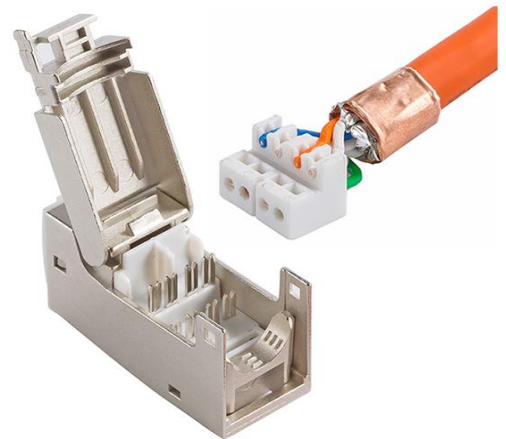

Standards Compliance

- ANSI/TIA-568.2-D
- ISO/IEC 11801-1, Class EA
- IEC 60603-7-1
- IEC 60512-99-002
- IEEE 802.3bt Type 4 PoE++ (4PPoE) 100 W
- ANSI/TIA-1096-A (formerly FCC Part 68)
- Cat.6A 90m Perm. Link Test Performance
- RoHS/REACH compliant

Part Number Descriptions

LW-KJ117-C7 Cat.7 STP Keystone Jack, Tool-Free, 90° LSA Termination

Dimensions (mm)

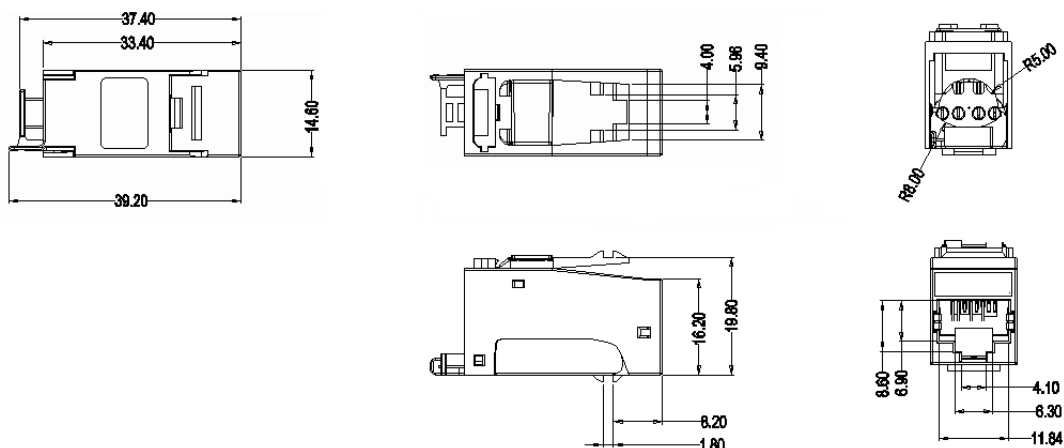

180° STP Keystone Jack, Linkwylan KJ28F, Tool-Free

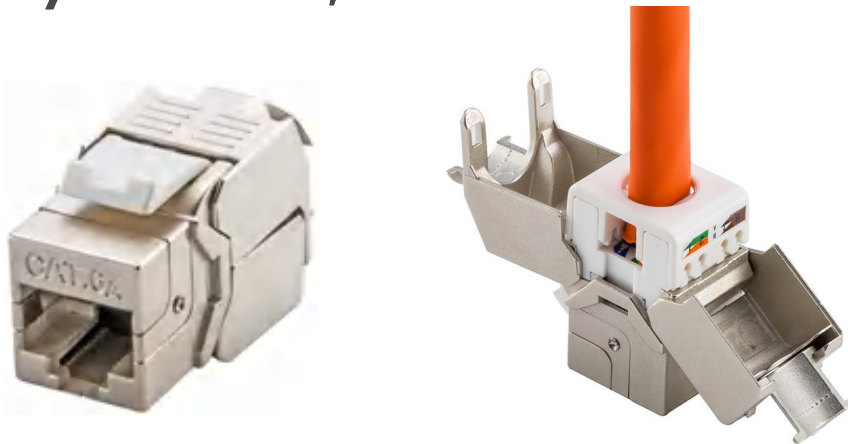

Features

- CTTL verified Cat 6A perm. link performance
- Delta verified ISO Cat 6A perm. link performance
- GHMT verified IEC60512-99-002 PoE type III 60W and IV 100W capability
- IEEE802.3bt type III and IV application
- Power over HDBaseT (PoHDBaseT - up to 100W)
- High quality connectors ensure system reliability and stability by press-fit assembly process
- IEC60603-7 dimensions and structural reliability complied
- Accepts LW 1U 24-Port and 1U 48-Port keystone panel
- L x W x H: 38 x 16 x 21mm

Applications

Wire Gauge (AWG)	Wire O.D. (mm)	Cable O.D. (mm)
26/7 – 23/1	1.0 - 1.45	6.0 - 8.5

Part No.	Description
LW-KJ28F-C6A	CAT6A keystone jack, full shielded, tool-free connection
LW-KJ28F-C6	CAT6 keystone jack, full shielded, channel level, tool-less type
LW-KJ28F-C5E	CAT5e keystone jack, full shielded, channel level, tool-less type

Dimensions (mm)

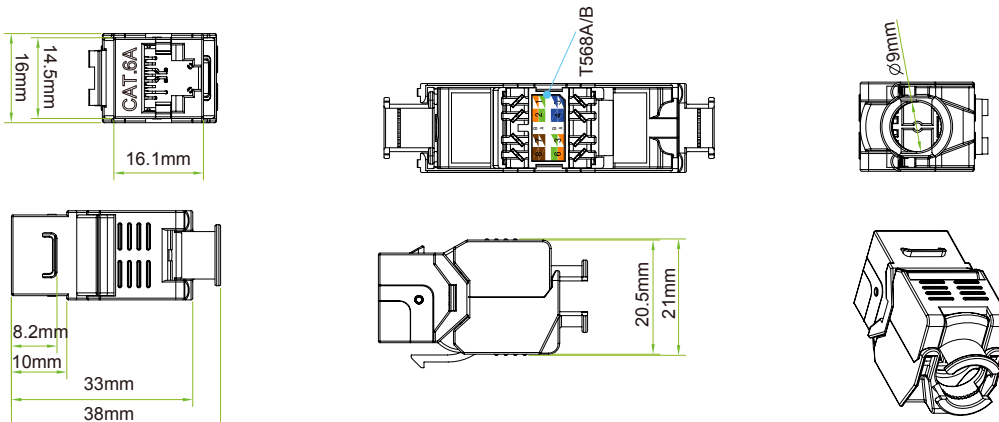

180° UTP Connecting-Hardware Keystone Jack, Tool-Free, ETL and FORCE Technology Verified

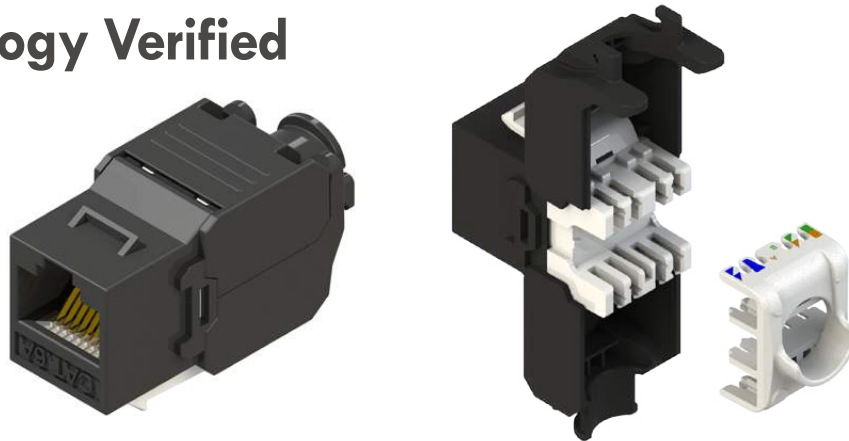

Features

- High-Density design for 1U-24port keystone panel, extreme performance design for Hyper-Scale and Edge Data Center
- FORCE Technology Verified ANSI/TIA-568.2-D Connecting-Hardware, including the 4PPoE performance
- ETL verified ANSI/TIA 568.2-D Cat.6A and ISO/IEC11801-1 Class EA 4-conductor Channel including the Cat.6A Alien Cross Talk performance
- Easy and Tool-Free in field termination, T568A & B wiring
- Power over HDBaseT™ (PoH) applications up to 100 W
- UL 1863 verified

Standards Compliance

- ANSI/TIA-568.2-D
- ISO/IEC 11801-1, Class D/E/EA
- IEC 60603-7
- IEC 60512-99-002
- IEEE 802.3bt Type 4 PoE++ (4PPoE) 100 W
- ANSI/TIA-1096-A (formerly FCC Part 68)
- UL1863
- RoHS/REACH compliant

Part Number Descriptions

LW-KM88U-C5E/XX	180° Cat.5E UTP Connecting-Hardware Keystone Jack, Tool-Free
LW-KM88U-C6/XX	180° Cat.6 UTP Connecting-Hardware Keystone Jack, Tool-Free
LW-KM88U-C6A/XX	180° Cat.6A UTP Connecting-Hardware Keystone Jack, Tool-Free

XX = Housing color, 01=Black, 02=Grey(RAL7030), 03=Red(RAL3003), 05=White(RAL9003), 06=Yellow(RAL1018), 07=Blue(RAL5012), 08=Green(RAL6016), 09=Orange(RAL2012), 13=Ivory(RAL1014)

Packing Information

- 1 keystone jack, 1 IDC-Cap & 1 Cable-Tie per bag
- 50 bags and 1 Installation-Instruction per box
- 10 boxes per carton (500 pcs/carton)
- Net weight 3.9 kgs per carton
- Gross weight 6.6 kgs per carton
- Carton size L48.0 x W39.0 x H25.3cm, 1.67 CUFT, 0.047CBM

Dimensions (mm)

Tolerance: ±0.3 mm

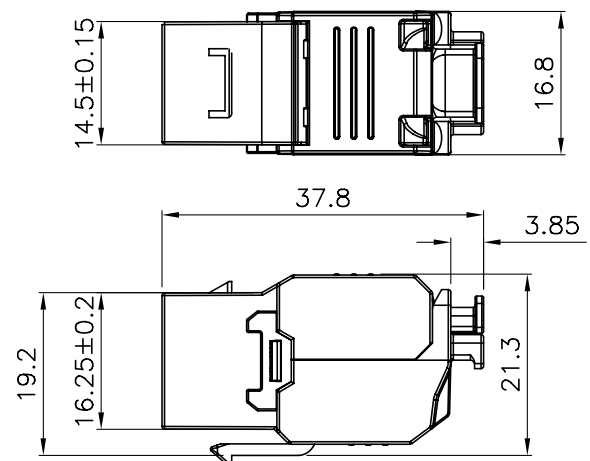
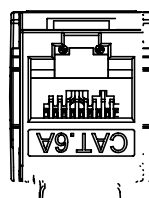

180° UTP Connecting-Hardware Keystone Jack, Tool-Free, Dust-Cap Type, ETL and FORCE Technology Verified

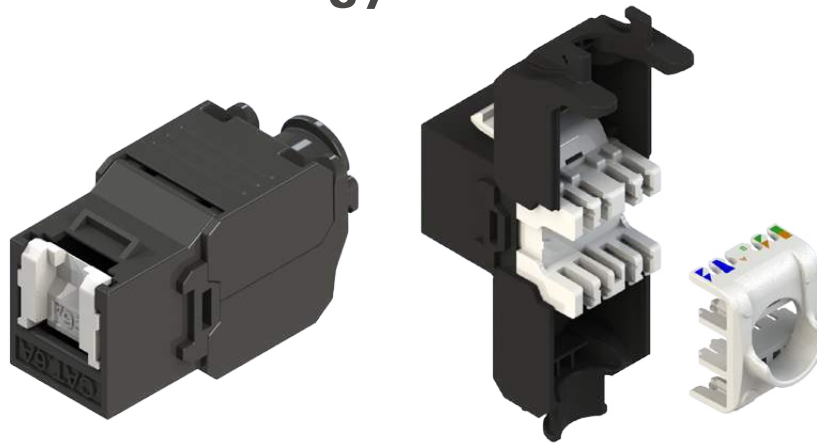

Features

- High-Density design for 1U-24port keystone panel, extreme performance design for Hyper-Scale and Edge Data Center
- FORCE Technology Verified ANSI/TIA-568.2-D Connecting-Hardware, including the 4PPoE performance
- ETL verified ANSI/TIA 568.2-D Cat.6A and ISO/IEC11801-1 Class EA 4-conductor Channel including the Cat.6A Alien Cross Talk performance
- Easy and Tool-Free in field termination, T568A & B wiring
- Power over HDBaseT™ (PoH) applications up to 100 W
- UL 1863 verified
- IP20 performance by Dust-Cap design

Standards Compliance

- ANSI/TIA-568.2-D
- ISO/IEC 11801-1, Class D/E/EA
- IEC 60603-7
- IEC 60512-99-002
- IEEE 802.3bt Type 4 PoE++ (4PPoE) 100 W
- ANSI/TIA-1096-A (formerly FCC Part 68)
- UL1863
- RoHS/REACH compliant

Part Number Descriptions

- LW-KM88U-C5ED/XX 180° Cat.5E UTP Connecting-Hardware Keystone Jack, Tool-Free, With Dust-Cap
- LW-KM88U-C6D/XX 180° Cat.6 UTP Connecting-Hardware Keystone Jack, Tool-Free, With Dust-Cap
- LW-KM88U-C6AD/XX 180° Cat.6A UTP Connecting-Hardware Keystone Jack, Tool-Free, With Dust-Cap

XX = Housing color, 01=Black, 02=Grey(RAL7030), 03=Red(RAL3003), 05=White(RAL9003), 06=Yellow(RAL1018), 07=Blue(RAL5012), 08=Green(RAL6016), 09=Orange(RAL2012), 13=Ivory(RAL1014)

Packing Information

- 1 keystone jack, 1 IDC-Cap & 1 Cable-Tie per bag
- 50 bags and 1 Installation-Instruction per box
- 10 boxes per carton (500 pcs/carton)
- Net weight 3.9 kgs per carton
- Gross weight 6.6 kgs per carton
- Carton size L48.0 x W39.0 x H25.3cm, 1.67 CUFT, 0.047CBM

Dimensions (mm)

Tolerance: ±0.3 mm

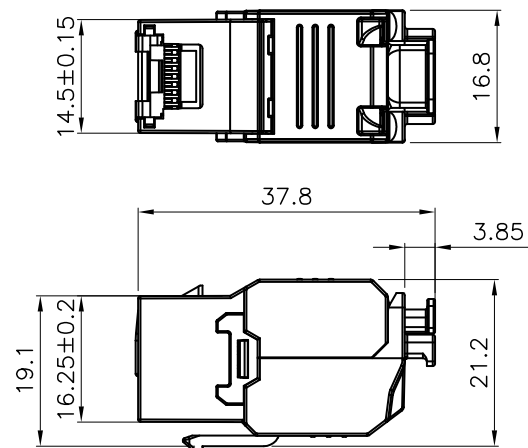
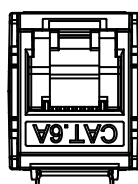

180° UTP Connecting-Hardware Keystone Jack, Punch-Down, Slim Size, ETL and FORCE Verified

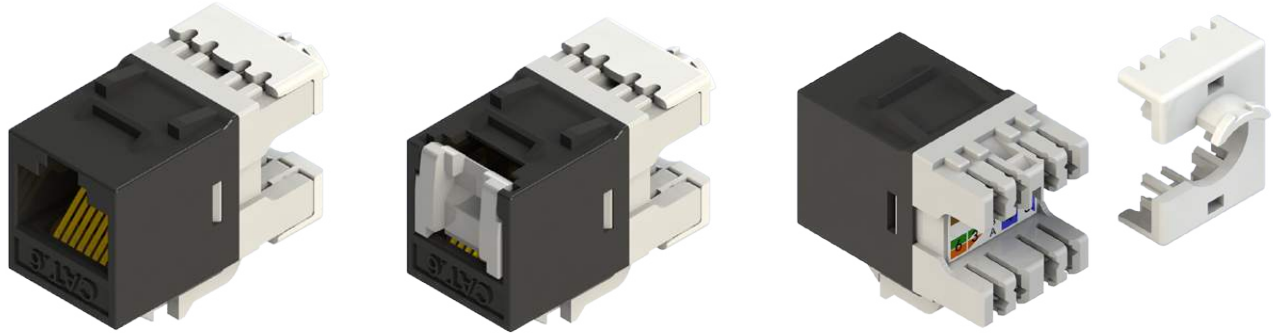

Features

- High-Density design for 1U-48port keystone panel, extreme performance design for Hyper-Scale and Edge Data Center
- ETL and FORCE Technology Verified ANSI/TIA-568.2-D Connecting-Hardware including the 4PPoE performance
- T568A & B wiring
- Power over HDBaseT™ (PoH) applications up to 100 W
- UL 1863 verified

Standards Compliance

- ANSI/TIA-568.2-D
- ISO/IEC 11801-1, Class D/E
- IEC 60603-7
- IEC 60512-99-002
- IEEE 802.3bt Type 4 PoE++ (4PPoE) 100 W
- ANSI/TIA-1096-A (formerly FCC Part 68)
- UL1863
- RoHS/REACH compliant

Part Number Descriptions

LW-KJ88-C5U/XX	180° Cat.5E UTP Connecting-Hardware Keystone Jack, Punch-Down, Slim Size
LW-KJ88-C6U/XX	180° Cat.6 UTP Connecting-Hardware Keystone Jack, Punch-Down, Slim Size
LW-KJ88-C5UD/XX	180° Cat.5E UTP Connecting-Hardware Keystone Jack, Punch-Down, Slim Size, With Dust-Cap
LW-KJ88-C6UD/XX	180° Cat.6 UTP Connecting-Hardware Keystone Jack, Punch-Down, Slim Size, With Dust-Cap

XX = Housing color, 01=Black, 02=Grey(RAL7030), 03=Red(RAL3003), 05=White(RAL9003), 06=Yellow(RAL1018), 07=Blue(RAL5012), 08=Green(RAL6016), 09=Orange(RAL2012), 13=Ivory(RAL1014)

Packing Information

- 1 keystone jack, 1 IDC-Cap & 1 Cable-Tie per bag
- 50 bags, 1 Punch-Support-Fixture & 1 Installation-Instruction per box
- 10 boxes per carton (500 pcs/carton)
- Net weight 3.2 kgs per carton
- Gross weight 6.0 kgs per carton
- Carton size L48.0 x W39.0 x H25.3cm, 1.67 CUFT, 0.047CBM

Dimensions (mm)

Tolerance: ±0.3 mm

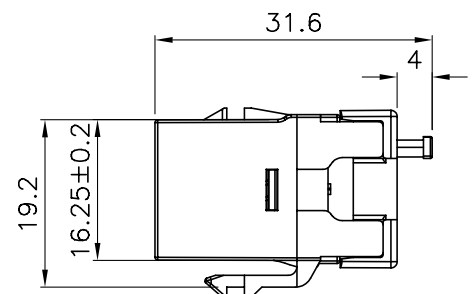
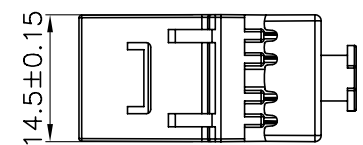
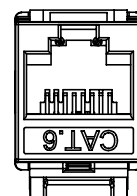

90° UTP Connecting-Hardware Keystone Jack, Punch-Down, Decora® Wall Plate compatible



Features

- High-Density design for 1U-48port keystone panel, extreme performance design for Hyper-Scale and Edge Data Center
- ETL verified ANSI/TIA 568.2-D Connecting-Hardware, Cat.6A including the Alien Cross Talk performance
- ETL verified ANSI/TIA 568.2-D Cat.6A and ISO/IEC11801-1 Class EA 4-conductor Channel including the Cat.6A Alien Cross Talk performance
- Fits for Decora® wall plate
- Pair Separation Tower of 110 IDC design
- Suitable for 110 Punch-Down tool and JE termination tool, T568A & B wiring
- Power over HDBaseT™ (PoH) applications up to 100 W
- UL 1863 verified

Standards Compliance

- ANSI/TIA-568.2-D
- ISO/IEC 11801-1, Class D/E/EA
- IEC 60603-7
- IEC 60512-99-002
- IEEE 802.3bt Type 4 PoE++ (4PPoE) 100 W
- ANSI/TIA-1096-A (formerly FCC Part 68)
- UL1863
- RoHS/REACH compliant

Part Number Descriptions

LW-KJ38U-C5/XX	KJ38-CE-US/XX	90° Cat.5E UTP Connecting-Hardware Keystone Jack, Punch-Down
LW-KJ38U-C6/XX	KJ38-C6-US/XX	90° Cat.6 UTP Connecting-Hardware Keystone Jack, Punch-Down
LW-KJ38U-C6A/XX	KJ38-6A-US/XX	90° Cat.6A UTP Connecting-Hardware Keystone Jack, Punch-Down

XX = Housing color, 01=Black, 02=Grey(RAL7030), 03=Red(RAL3003), 05=White(RAL9003), 06=Yellow(RAL1018), 07=Blue(RAL5012), 08=Green(RAL6016), 09=Orange(RAL2012), 13=Ivory(RAL1014)

Packing Information

- 1 keystone jack & 1 IDC-Cap per bag
- 50 bags, 1 Punch-Support-Fixture & 1 Installation-Instruction per box
- 10 bags boxes per carton (500/carton)
- Net weight 4.3 kgs per carton
- Gross weight 6.9 kgs per carton
- Carton size L48.0 x W39.0 x H25.3cm, 1.67 CUFT, 0.047CBM

Dimensions (mm)

Tolerance: ±0.3 mm

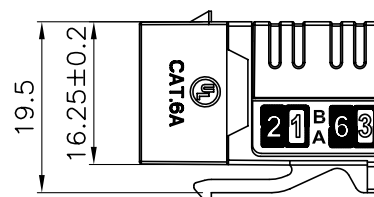
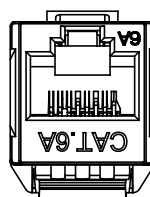
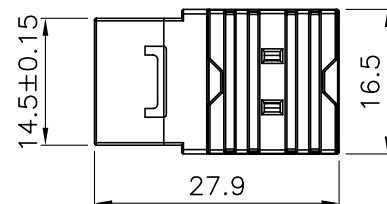

180° UTP Keystone Jack, Linkwylan KJ28U, Tool-Free



Features

- Available in Cat.5e/6/6A
- Performance comply with TIA, ISO/IEC 11801 perm. link
- IEC60512-99-002 PoE type III 60W and IV 100W capability
- IEEE802.3bt type III and IV application
- Power over HDBaseT (PoHDBaseT - up to 100W)
- IEC60603-7 dimensions and structural reliability complied
- Fits 1U 24-Port, 1U 48-Port and 0.5U 24-Port keystone panel
- Fast termination without any special punch down tool
- L x W x H: 35.9 x 14.6 x 22.8mm



Part No.	Description
LW-KJ28-C5EUXX	Cat 5e keystone jack, unshielded, RJ45 to LSA, tool-free, color xx
LW-KJ28-C6UXX	Cat 6 keystone jack, unshielded, RJ45 to LSA, tool-free, color xx
LW-KJ28-C6AUXX	Cat 6A keystone jack, unshielded, RJ45 to LSA, tool-free, color xx

Dimensions (mm)

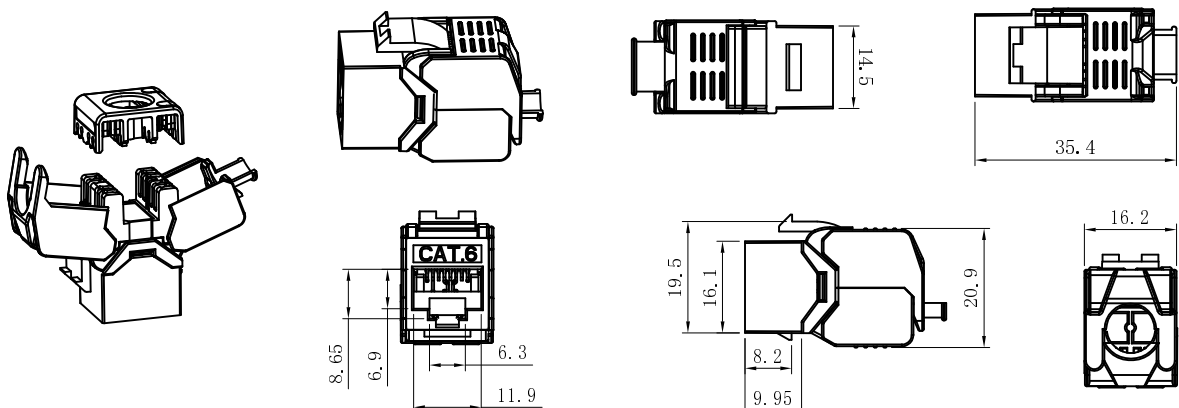

LAN Cable Extension Connector

STP, Tool-Free, Fast Field Connection

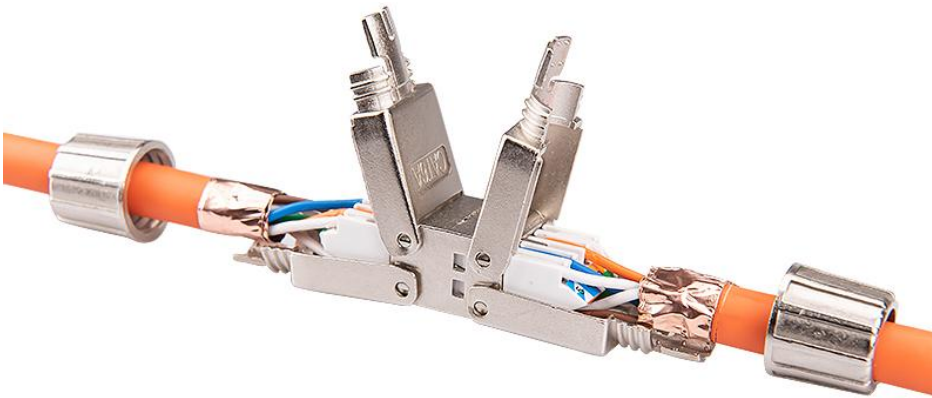

Features

- IEC60512-99-002 PoE type III 60W and IV 100W capability
- IEEE802.3bt type III and IV application
- Power over HDBaseT (PoHDBaseT - up to 100W)
- IEC60603-7 dimensions and structural reliability complied
- Accepts copper wires 22-24AWG (LW-CEC-C6AS/7S), 23-26AWG (LW-CS117-BK, LW-CS117-MT)
- Accepts cable O.D. 6.0 to 8.5mm
- High quality connectors ensure system reliability and stability by full automation line
- L x W x H: 75 x 14.6 x 15mm
- Toolless Termination, no need crimping tool
- With metal screw type boot, repeatable using available
- Zinc-Alloy diecasting body, provide 360 degree full shielded

Part No.	Description
LW-CEC-C6AS	Cat 6A Cable Extension Connector, Shielded, Toolless, Metal Boot
LW-CEC-C7S	Cat 7 Cable Extension Connector, Shielded, Toolless, Metal Boot
LW-CS117-BK	Cat 5e/6/7 Universal Cable Extension Connector, STP, Toolless, Plastic Boot
LW-CS117-MT	Cat 5e/6/7 Universal Cable Extension Connector, STP, Toolless, Metal Boot



In-Line Coupler, Keystone Type RJ45 Female To Female Adapter

Features

- Fluke tested channel performance
- UL 94V-2 plastic
- IEC60512-99-002 PoE type III 60W and IV 100W capability
- IEEE802.3bt type III and IV application
- Power over HDBaseT (PoHDBaseT - up to 100W)
- IEC60603-7 dimensions and structural reliability complied
- Fits for LW 1U 24-port blank patch panel
- High quality connectors ensure system reliability and stability by automation line

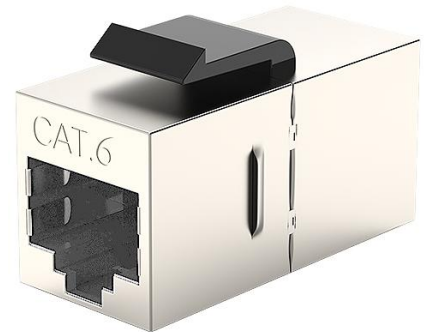

Part No.	Description
LW-AD-6AS	RJ45 CAT 6A female in-line coupler keystone adapter, shielded type
LW-AD-6S	RJ45 CAT 6 female in-line coupler keystone adapter, shielded type
LW-AD-5S	RJ45 CAT 5e female in-line coupler keystone adapter, shielded type

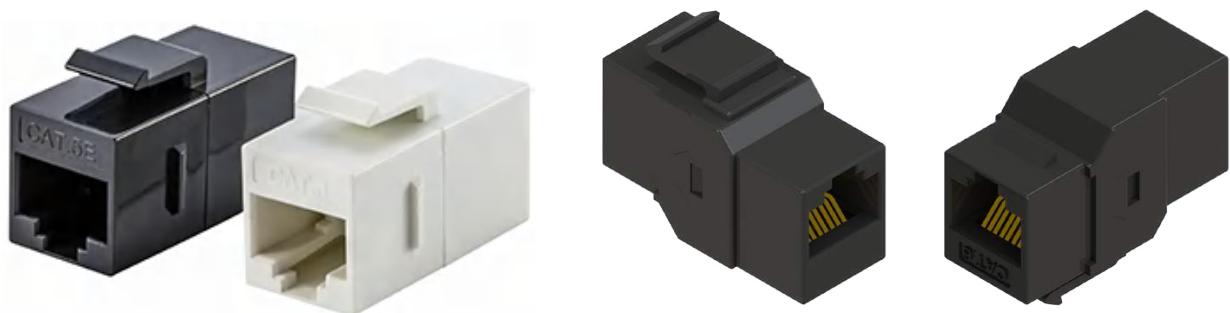

Part No.	Description
LW-AD-6AU	RJ45 CAT 6A female in-line coupler keystone adapter, unshielded
LW-AD-6U	RJ45 CAT 6 female in-line coupler keystone adapter, unshielded
LW-AD-5U	RJ45 CAT 5e female in-line coupler keystone adapter, unshielded

RJ45 Water-Proof In-Line Coupler IP68, Shielded Type, nylon PA66 Material



LW-WP23-C6AS01



LW-WP23-C6S02



LW-WP23-C6S01

Features

- Quick and easy In-Field installation for Water-Proof applications
- Compliant with the ANSI/TIA-568.2-D Cat.6 Channel and ISO/IEC 11801-1 Cat.6A Class EA performance

Part Number

LW-WP23-C6AS01
LW-WP23-C6S01
LW-WP23-C6S02

Descriptions

IP68 Water-Proof Adapter, Cat.6A STP, Fee Through Type
IP68 Water-Proof Adapter, Cat.6 STP, Panel/Plate Mountable
IP68 Water-Proof Adapter, Cat.6 STP, Panel/Plate Mountable, Short Type

Dimensions (mm)

Tolerance: ± 0.3 mm

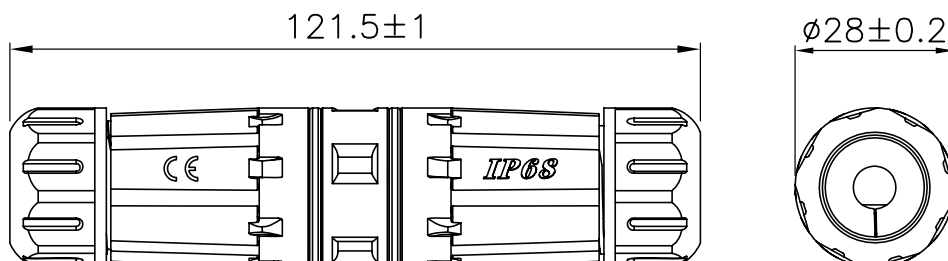

Cat.8 S/FTP 22 AWG Pre-Terminated Patch Cord



Features

- PCB compensation design for further Cat.8 component patch cord requirement
- GHMT verified ISO/IEC11801-1 Class I performance up to 2000MHz
- 100% Cat.8 performance tested in factory
- Perfect EMC performance, robust and durable structure by the Full-Shielded Die-Casting material Field-Term plug and S/FTP cable
- Power over HDBaseT™ (PoH) applications up to 100 W

Standards Compliance

- ANSI/TIA-568.2-D
- ISO/IEC 11801-1, Class I
- IEC 60603-7-1
- IEC 60512-99-002
- IEEE 802.3bt type 4 PoE++(4PPoE) 100 W
- ANSI/TIA-1096-A (formerly FCC Part 68)
- UL444 (for UL CM PVC jacket material only)
- IEC 61935-2
- IEC 61034-2 Smoke (for LSZH material only)
- IEC 60754-2 Halogen/Acid (for LSZH material only)
- RoHS /REACH compliant

Part Number Descriptions

LW-PTC8S-010/YL Cat.8 S/FTP 22 AWG Field Termination Plug Patch Cord, T568B, LSZH, yellow color, 1m

LW-PTC8X-XXX/YL (1) (2)	X (1) Jacket material XXX (2) Length	S=LSZH, P=UL CM PVC, 005=0.5 meter, 010=1 meters, 100=10 meters
----------------------------	---	--

Dimensions (mm)

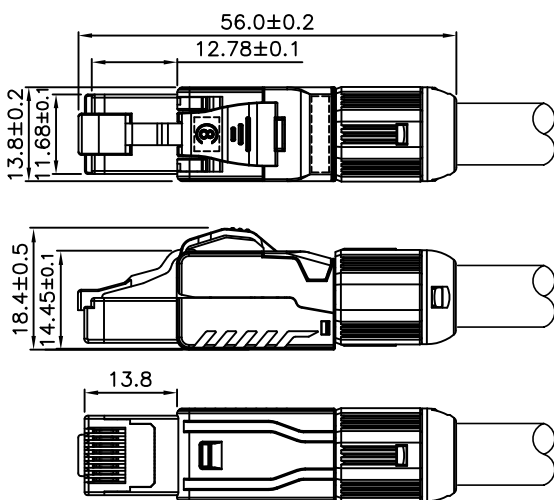

Length Information, at 20°C

- Length Available :
 - 2-connector 30m Channel : 1m to 5m
 - Point to Point (w/o Perm. Link) : 1m to 30m
- Length Tolerance :
 - 1m : +20/-0cm
 - 2m to 30m : ±20cm
- 30m Channel Linking Information :

Cord A	Perm. Link	Cord B	
1m	24m	5m	Channel & 4PPoE
2m	24m	4m	Channel & 4PPoE
3m	24m	3m	Channel & 4PPoE
2m	26m	2m	Channel & 4PPoE

Specifications Patch cord (IEC 61935-2, Patch Cord Reliability)

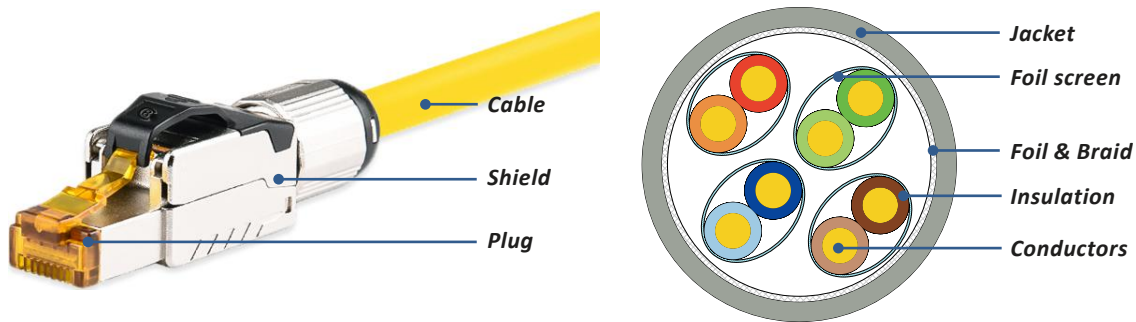

Life (Mating cycles)	Min. 750 cycles
Pulling tension	50 N for 60 s
Strain relief	50 N for 60 s in all direction
Flexing	2 N for 500 cycles, 20 cycles per 60 s
Bend radius	8x of cable O.D.
Insulation resistance	≥ 500 MΩ at 100 Vdc, for 60 s
Voltage proof	Contact to contact 1000 Vdc, contact to shield 1500 Vdc, for 60 s
Installing temperature	0°C to 50°C (32°F to 122°F)
Storage temperature	-40°C to 75°C, under static conditions
Operating temperature	-20°C to 60°C, under static conditions

Cable

- Conductors Bare copper, 22 AWG, 1 x 0.63±0.01 mm
- Insulation Foam PE, O.D. 1.58±0.05 mm
- Foil Screen Aluminum/PET on each pair & Oval
- Braid Tinned copper wires, approx 40% coverage
- Drain wire n/a
- Jacket 0.65 mm (nominal) thickness, O.D. 8.4±0.3 mm
- Cross filler (separator) n/a

Printing on the cable

- **LSZH** S/FTP INSTALL CABLE 22 AWG 4PR LSZH ISO/IEC 11801 CLASS I & ANSI/TIA-568.2-D CAT.8 XXXXXX-X XXXM
- **CM PVC** S/FTP INSTALL CABLE 22 AWG 4PR C(UL)US TYPE CM 75°C ISO/IEC 11801 CLASS I & ANSI/TIA-568.2-D CAT.8 XXXXXX-X XXXM

Plug

- Conductors Min. 0.3 mm thickness phosphor bronze
- Gold plating 50 micro-inch gold plating over nickel plating on contact area
- Housing Polycarbonate, UL94V-2, transparent yellow color
- Shield Zinc Die-Casting with nickel plating
- Contact resistances ≤ 20 mΩ
- PCB UL94V-0

40G Cat.8 S/FTP 22 AWG Pre-Terminated Patch Cord Cable With PET-Braid



Features

- PCB compensation design for 4K/8K TV application
- Compliant with the ISO/IEC11801-1 Class I performance up to 2000MHz
- 100% Cat.8 performance tested in factory
- Perfect EMC performance, robust and durable structure by the Full-Shielded Die-Casting material Field-Term plug and Nylon-Braid protection on S/FTP cable
- Power over HDBaseT™(PoH) applications up to 100 W

Standards Compliance

- ANSI/TIA-568.2-D
- ISO/IEC 11801-1, Class I
- IEC 60603-7-1
- IEC 60512-99-002
- IEEE 802.3bt type 4 PoE++(4PPoE) 100 W
- ANSI/TIA-1096-A (formerly FCC Part 68)
- UL444 (for UL CM PVC jacket material only)
- IEC 61935-2
- IEC 61034-2 Smoke (for LSZH material only)
- IEC 60754-2 Halogen/Acid (for LSZH material only)
- RoHS /REACH compliant

Part Number Descriptions

LW-PTC8S-010/BR Cat.8 S/FTP 22 AWG Pre-Terminated Patch Cord, With Black PET-Braid, 1m

LW-PTC8X-XXX/BR
(1) (2)

X (1) Jacket material
XXX (2) Length

S=LSZH, P=UL CM PVC,
005=0.5 meter, 010=1 meters, 100=10 meters

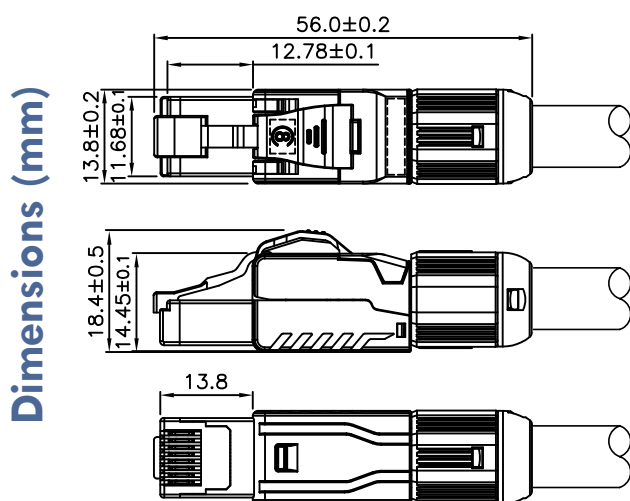

Length Information, at 20°C

- Length Available :
 - 2-connector 30m Channel : 1m to 5m
 - Point to Point (w/o Perm. Link) : 1m to 30m
 - Length Tolerance :
 - 1m : +20/-0cm
 - 2m to 30m : ±20cm
 - 30m Channel Linking Information :
- | Cord A | Perm. Link | Cord B | |
|--------|------------|--------|-----------------|
| 1m | 24m | 5m | Channel & 4PPoE |
| 2m | 24m | 4m | Channel & 4PPoE |
| 3m | 24m | 3m | Channel & 4PPoE |
| 2m | 26m | 2m | Channel & 4PPoE |

Specifications Patch cord (IEC 61935-2, Patch Cord Reliability)

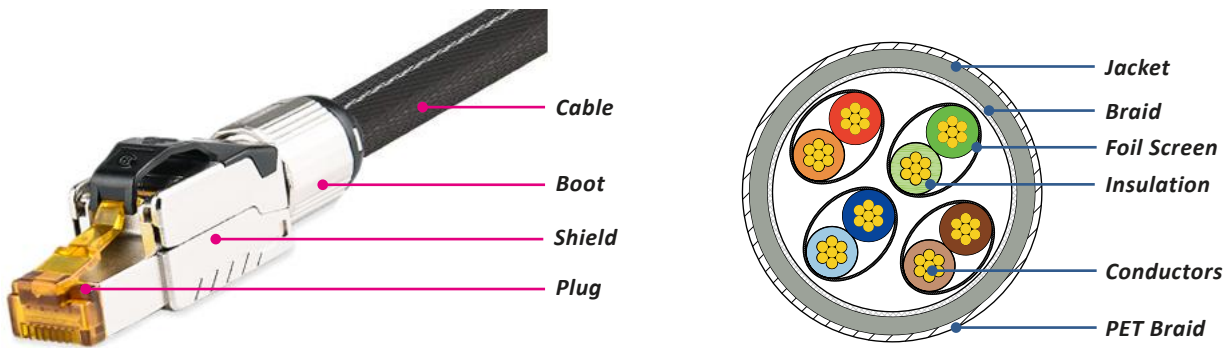

Life (Mating cycles)	Min. 750 cycles
Pulling tension	50 N for 60 s
Strain relief	50 N for 60 s in all direction
Flexing	2 N for 500 cycles, 20 cycles per 60 s
Bend radius	8x of cable O.D.
Insulation resistance	≥ 500 MΩ at 100 Vdc, for 60 s
Voltage proof	Contact to contact 1000 Vdc, contact to shield 1500 Vdc, for 60 s
Installing temperature	0°C to 50°C (32°F to 122°F)
Storage temperature	-40°C to 75°C, under static conditions
Operating temperature	-20°C to 60°C, under static conditions

Cable

- Conductors Bare copper, 22 AWG, 1 x 0.63±0.01 mm
- Insulation Foam PE, O.D. 1.58±0.05 mm
- Foil Screen Aluminum/PET on each pair
- Braid Tin plated copper, 30% coverage
- Drain wire n/a
- Jacket 0.65 mm (nominal) thickness, O.D. 8.6±0.2 mm
- Cross filler (separator) n/a
- Jacket protection PET

Printing on the cable

- **LSZH** S/FTP PATCH CABLE 24 AWG 4PR LSZH ISO/IEC 11801 CLASS I & ANSI/TIA-568.2-D CAT.8 XXXXXXXX-X
- **CM PVC** S/FTP PATCH CABLE 24 AWG 4PR E178558 C(UL)US TYPE CM 75°C ISO/IEC 11801 CLASS I & ANSI/TIA-568.2-D CAT.8 XXXXXXXX-X

Plug

- Conductors Min. 0.3 mm thickness phosphor bronze
- Gold plating 50 micro-inch gold plating over nickel plating on contact area
- Housing Polycarbonate, UL94V-2, transparent yellow color
- Shield Zinc Die-Casting with nickel plating
- Contact resistances ≤ 20 mΩ
- PCB UL94V-0

Cat.6A & Cat.7 S/FTP 23 AWG Pre-Terminated Patch Cord

- Length Available :
2-connector 94m Channel : 1m to 5m
Point to Point (w/o Perm. Link) : 1m to 94m
- Length Tolerance :
1m : +20/-0cm
2m to 30m : ±20cm



Features

- PCB compensation design for 10Gbit Cat.6A & Cat.7 component patch cord requirement
- GHMT verified ISO/IEC11801 Class Ea 500MHz, Class F 600MHz
- 100% performance tested in factory
- Perfect EMC performance, robust and durable structure by the Full-Shielded Die-Casting material Field-Term plug and S/FTP cable
- Power over HDBaseT™ (PoH) applications up to 100 W

Standards Compliance

- ANSI/TIA-568.2-D
- ISO/IEC 11801
- IEC 60603-7-1
- IEC 60512-99-002
- IEEE 802.3bt type 4 PoE++(4PPoE) 100 W
- ANSI/TIA-1096-A (formerly FCC Part 68)
- UL444 (for UL CM PVC jacket material only)
- IEC 61935-2
- IEC 61034-2 Smoke (for LSZH material only)
- IEC 60754-2 Halogen/Acid (for LSZH material only)
- RoHS /REACH compliant

Part Number Descriptions

LW-PTC6A-010/BL	Cat.6A S/FTP 23 AWG Field Termination Plug Patch Cord, T568B, LSZH, Blue Color, 1m
LW-PTC7S-010/OR	Cat.7 S/FTP 23 AWG Field Termination Plug Patch Cord, T568B, LSZH, Orange Color, 1m

LW-PTC7S-XXX/YL
(1) (2)

X (1) Jacket material
XXX (2) Length

S=LSZH, P=UL CM PVC,
005=0.5 meter, 010=1 meters, 100=10 meters

Dimensions (mm)

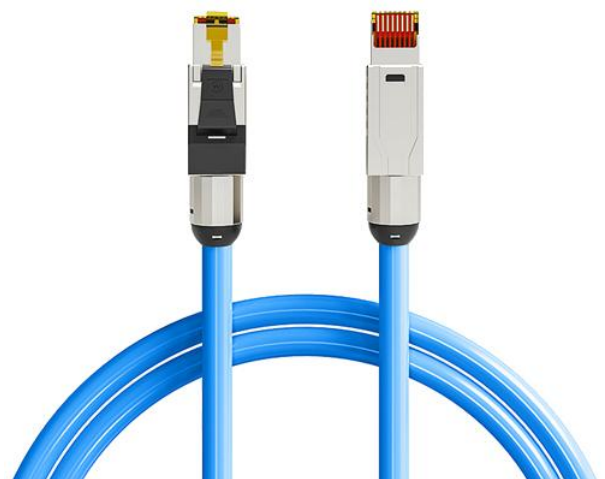
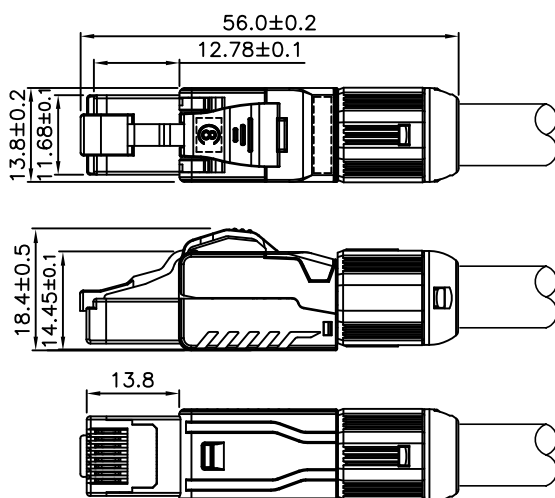

Specifications Patch cord (IEC 61935-2, Patch Cord Reliability)

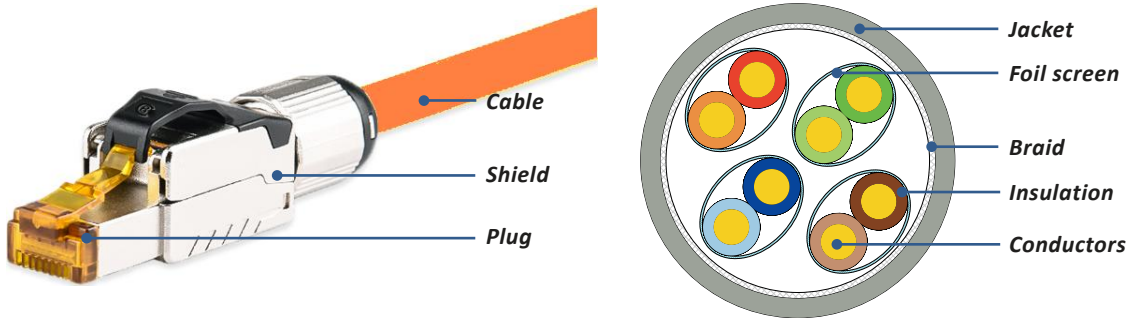

Life (Mating cycles)	Min. 750 cycles
Pulling tension	50 N for 60 s
Strain relief	50 N for 60 s in all direction
Flexing	2 N for 500 cycles, 20 cycles per 60 s
Bend radius	8x of cable O.D.
Insulation resistance	≥ 500 MΩ at 100 Vdc, for 60 s
Voltage proof	Contact to contact 1000 Vdc, contact to shield 1500 Vdc, for 60 s
Installing temperature	0°C to 50°C (32°F to 122°F)
Storage temperature	-40°C to 75°C, under static conditions
Operating temperature	-20°C to 60°C, under static conditions

Cable

- Conductors Bare copper, 23 AWG, 1 x 0.56±0.01 mm
- Insulation Foam PE, O.D. 1.35±0.05 mm
- Foil Screen Aluminum/PET on each pair
- Braid Tinned copper wires, approx 30% coverage
- Drain wire n/a
- Jacket 0.50 mm (nominal) thickness, O.D. 7.2±0.3 mm
- Cross filler (separator) n/a

Printing on the cable

- **LSZH** LINKWYLAN 4x2x23# S/FTP CATEGORY 7 SHIELDED LSOH CABLE VERIFIED TO ISO/IEC-11801 & IEC 60332-1 CE 2002/95/EC (Meter Mark)
- **CM PVC** LINKWYLAN CAT.7 S/FTP CABLE 23 AWG 4PR C(UL)US TYPE CM 75°C ISO/IEC 11801 & ANSI/TIA-568.2-D XXXM

Plug

- Conductors Min. 0.3 mm thickness phosphor bronze
- Gold plating 50 micro-inch gold plating over nickel plating on contact area
- Housing Polycarbonate, UL94V-2, transparent yellow color
- Shield Zinc Die-Casting with nickel plating
- Contact resistances ≤ 20 mΩ
- PCB UL94V-0

Cat.8 S/FTP 24 AWG PCB Patch Cord



Features

- PCB compensation design for further Cat.8 component patch cord requirement
- GHMT verified ISO/IEC11801-1 Class I up to 2000MHz
- 100% Cat.8 performance tested in factory
- Perfect EMC performance, robust and durable structure by the Full-Shielded plug design and S/FTP cable
- Power over HDBaseT™ (PoH) applications up to 100 W

Standards Compliance

- ANSI/TIA-568.2-D
- ISO/IEC 11801-1, Class I
- IEC 60603-7-1
- IEC 60512-99-002
- IEEE 802.3bt type 4 PoE++(4PPoE) 100 W
- ANSI/TIA-1096-A (formerly FCC Part 68)
- UL444 (for UL CM PVC jacket material only)
- IEC 61935-2
- IEC 61034-2 Smoke (for LSZH material only)
- IEC 60754-2 Halogen/Acid (for LSZH material only)
- RoHS /REACH compliant

Part Number Descriptions

LW-CA8SH-300/YL Cat.8 S/FTP 24 AWG PCB Patch Cord, T568B, LSZH, yellow color, 30m

LW-CA8SX-XXX/XX	x (1) Jacket material	H=LSZH, P=UL CM PVC,
(1) (2) (3)	xxx (2) Length	010=1 meter, 050=5 meters, 300=30 meters
	xx (3) Cable color	YL=Yellow, RD=Red, BL=Blue, BK=Black, WH=White

Dimensions (mm)

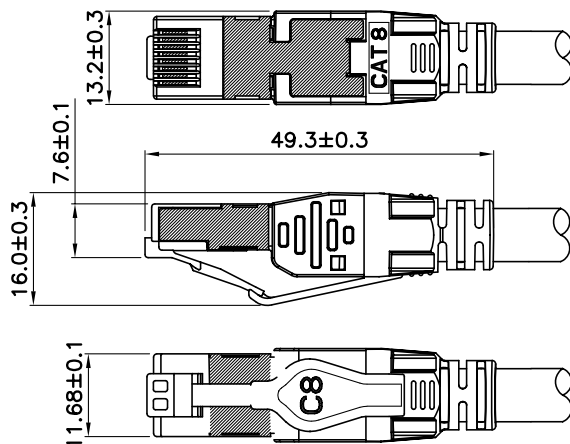

Length Information, at 20°C

- Length Available :
 - 2-connector 30m Channel : 1m to 5m
 - Point to Point (w/o Perm. Link) : 1m to 30m
- Length Tolerance :
 - 1m : +20/-0cm
 - 2m to 30m : ±20cm
- 30m Channel Linking Information :

Cord A	Perm. Link	Cord B	
1m	24m	5m	Channel & 4PPoE
2m	24m	4m	Channel & 4PPoE
3m	24m	3m	Channel & 4PPoE
2m	26m	2m	Channel & 4PPoE

Specifications Patch cord (IEC 61935-2, Patch Cord Reliability)

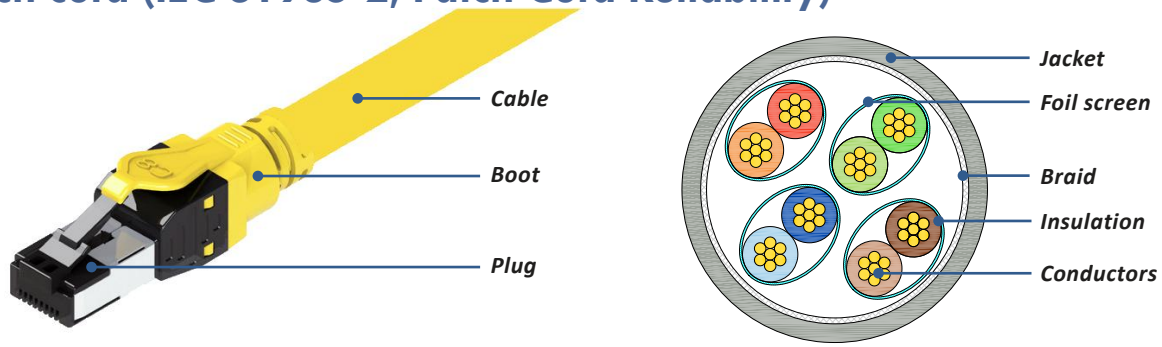

Life (Mating cycles)	Min. 750 cycles
Pulling tension	50 N for 60 s
Strain relief	50 N for 60 s in all direction
Flexing	2 N for 500 cycles, 20 cycles per 60 s
Bend radius	Min. 58.4 mm, 8x of cable O.D.
Insulation resistance	≥ 500 MΩ at 100 Vdc, for 60 s
Voltage proof	Contact to contact 1000 Vdc, contact to shield 1500 Vdc, for 60 s
Installing temperature	0°C to 50°C (32°F to 122°F)
Storage temperature	-40°C to 70°C (-40°F to 158°F), under static conditions
Operating temperature	-10°C to 60°C (14°F to 140°F), under static conditions

Cable

- Conductors Bare copper, 24 AWG, 7 x 0.192±0.005 mm
- Insulation Foam PE, O.D. 1.4±0.03 mm
- Foil Screen Aluminum/PET on each pair
- Braid Tin plated copper, min. 30% coverage
- Drain wire n/a
- Jacket 0.65 mm (nominal) thickness, O.D. 7.3±0.2 mm
- Cross filler (separator) n/a

Printing on the cable

- LSZH S/FTP PATCH CABLE 24 AWG 4PR LSZH ISO/IEC 11801 CLASS I & ANSI/TIA-568.2-D CAT.8 XXXXXX-X
- CM PVC S/FTP PATCH CABLE 24 AWG 4PR E178558 C(UL)US TYPE CM 75°C ISO/IEC 11801 CLASS I & ANSI/TIA-568.2-D CAT.8 XXXXXX-X

Plug

- Conductors Min. 0.3 mm thickness phosphor bronze
- Gold plating 50 micro-inch gold plating over nickel plating on contact area
- Housing PC, UL94V-2
- Shield Brass with nickel plating
- Contact resistances ≤ 20 mΩ
- PCB UL94V-0

Boot

- Assembly boot PC, UL94V-2, yellow color

RJ 45 Patch Cord, Cat 5e UTP, PVC or LSZH Jacket

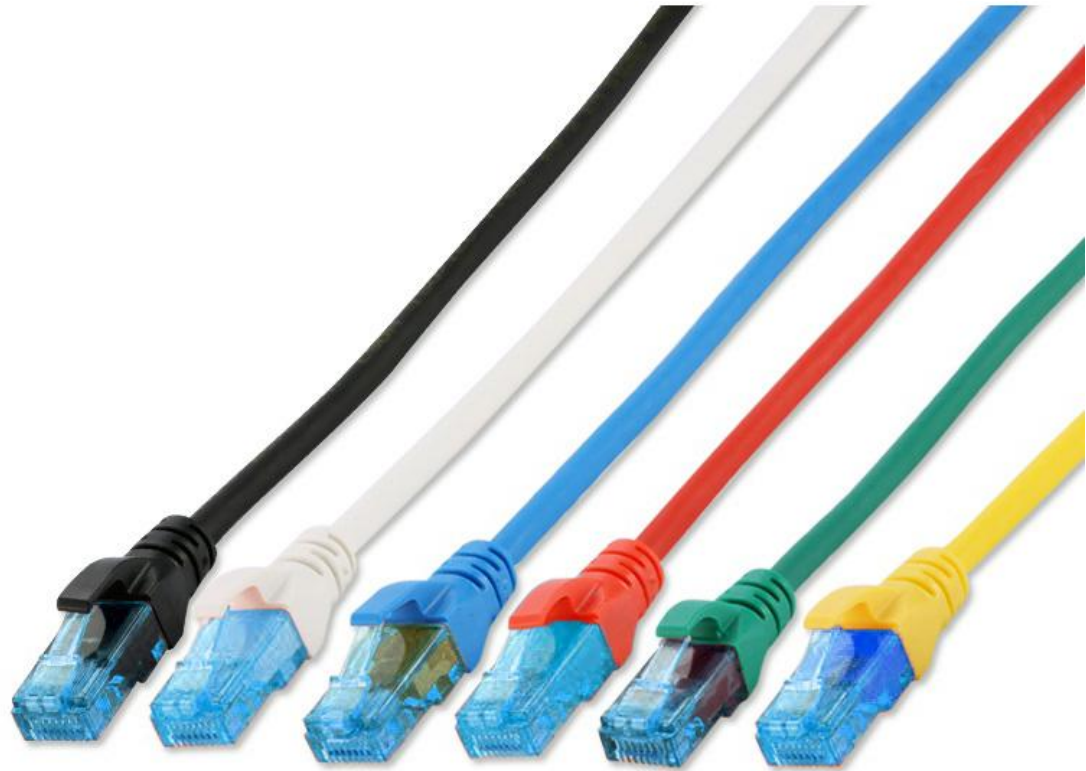

Features

- Cat 5e UTP patch cord, TIA/EIA-568.D-2, ISO/IEC 11801-1 Class D channel performance
- Bare copper wires, stranded
- UTP AWG26/7, LSZH or PVC jacket, cable outer diameter is about 5.0mm
- Support 100/1000M Base-T, transmission up to 1000Mbps 100MHz
- Different length, different cable colors are available
- CM, LSZH (IEC60332-1-2 / IEC 60332-3-24) and CM-LSZH dual rated jacket are available
- IEC60603-7 and IEC61935-2 dimensions and structural reliability complied
- PC UL94V-0 or V-2 for plug material, gold plating on plug contact area
- Molding type boot, different cable colors are available

Part Number	Description
LW-CA5U-XXX/XX	Cat.5e UTP Patch Cord, Copper AWG 26/7, PVC, Length XXX m, Color XX
LW-CA5UH-XXX/XX	Cat.5e UTP Patch Cord, Copper AWG 26/7, LSZH, Length XXX m, Color XX

LW-CA5U-XXX/XX	x (1) Cable Length	0015=0.15m, 005=0.5m, 050=5m, 100=10m...
(1) (2)	xxx (2) Cable Color	BK=Black, WH=White, RD=Red, BL=Blue...

RJ 45 Patch Cord, Cat 5e FTP, PVC or LSZH Jacket

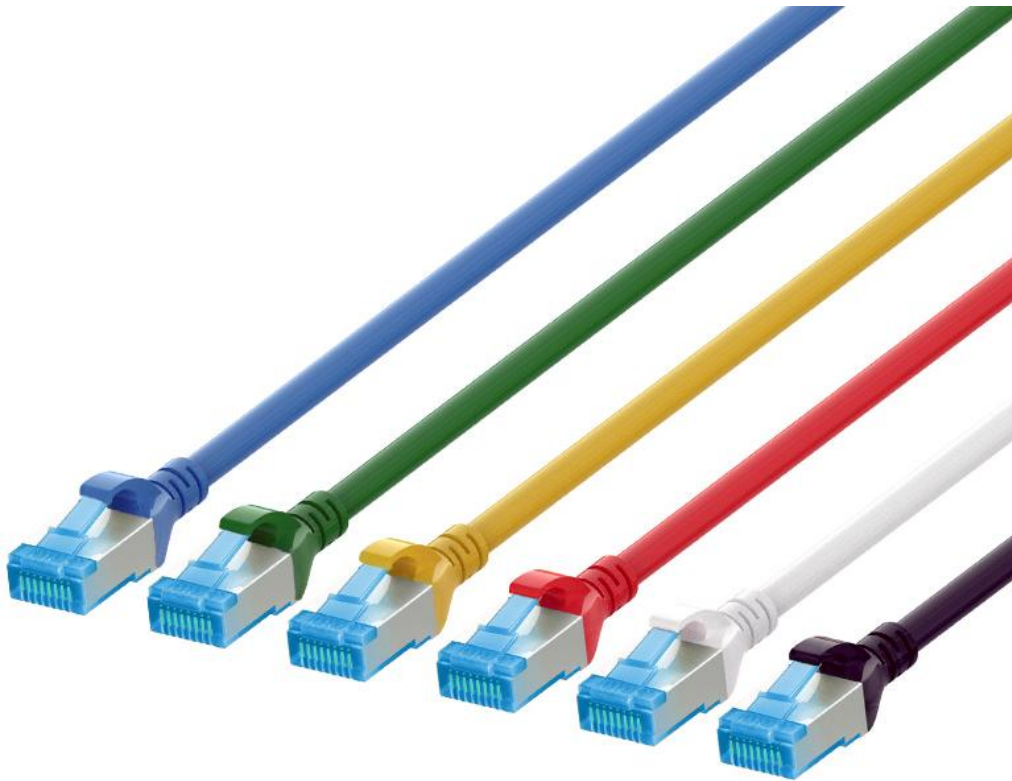

Features

- Cat 5e FTP patch cord, TIA/EIA-568.D-2, ISO/IEC 11801-1 Class D channel performance
- Bare copper or CCA wires, stranded
- F-UTP AWG26/7, LSZH or PVC jacket, cable outer diameter is about 5.5mm
- Support 100/1000M Base-T, transmission up to 1000Mbps 100MHz
- Different length, different cable colors are available
- CM, LSZH (IEC60332-1-2 / IEC 60332-3-24) and CM-LSZH dual rated jacket are available
- IEC60603-7 and IEC61935-2 dimensions and structural reliability complied
- PC UL94V-0 or V-2 for plug material, gold plating on plug contact area
- Molding type boot, different cable colors are available

Part Number	Description
LW-CA5F-XXX/XX	Cat.5e FTP Patch Cord, Copper AWG 26/7, PVC, Length XXX m, Color XX
LW-CA5FH-XXX/XX	Cat.5e FTP Patch Cord, Copper AWG 26/7, LSZH, Length XXX m, Color XX

LW-CA5F-XXX/XX	x (1) Cable Length	0015=0.15m, 005=0.5m, 050=5m, 100=10m...
(1) (2)	xxx (2) Cable Color	BK=Black, WH=White, RD=Red, BL=Blue...

RJ 45 Patch Cord, Cat 6 UTP, PVC or LSZH Jacket



Features

- Cat 6 UTP patch cord, TIA/EIA-568.D-2, ISO/IEC 11801-1 Class E channel performance
- Bare copper wires, stranded
- UTP AWG26/7, LSZH or PVC jacket, cable outer diameter is about 5.5mm
- Support 100/1000M Base-T, transmission up to 1 Gigabit 250MHz
- Different length, different cable colors are available
- CM, LSZH (IEC60332-1-2 / IEC 60332-3-24) and CM-LSZH dual rated jacket are available
- IEC60603-7 and IEC61935-2 dimensions and structural reliability complied
- PC UL94V-0 or V-2 for plug material, gold plating on plug contact area
- Molding type boot, different cable colors are available

Part Number	Description
LW-CA6U-XXX/XX	Cat.6 UTP Patch Cord, Copper AWG 26/7, PVC, Length XXX m, Color XX
LW-CA6UH-XXX/XX	Cat.6 UTP Patch Cord, Copper AWG 26/7, LSZH, Length XXX m, Color XX

LW-CA6U-XXX/XX	x (1) Cable Length	0015=0.15m, 005=0.5m, 050=5m, 100=10m...
(1) (2)	xxx (2) Cable Color	BK=Black, WH=White, RD=Red, BL=Blue...

RJ 45 Patch Cord, Cat 6 FTP & SFTP, PVC or LSZH

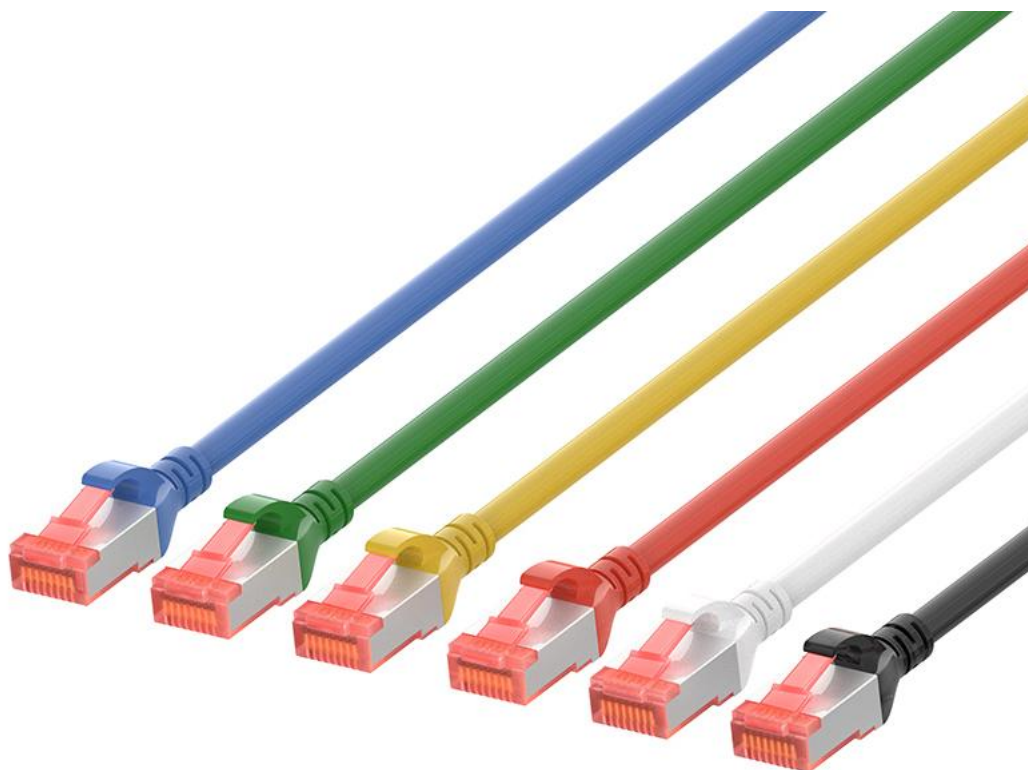

Features

- Cat 6 FTP & SFTP patch cord, TIA/EIA-568.D-2, ISO/IEC 11801-1 Class E channel performance
- SFTP (28AWG Bare copper wires, stranded), FTP (26AWG CCA wires, stranded)
- F-UTP AWG26//7, cable outer diameter is about 6.0mm, SFTP AWG28/7, cable O.D 6.0mm
- IEC60512-99-002 POE type III 60W and IV 100W capability
- Different length, different cable colors are available
- CM, LSZH (IEC60332-1-2 / IEC 60332-3-24) and CM-LSZH dual rated jacket are available
- Support 100/1000M Base-T, transmission up to 1 Gigabit 250MHz
- PC UL94V-0 or V-2 for plug material, gold plating on plug contact area
- Molding type boot, different cable colors are available

Part Number	Description
LW-CA6F-XXX/XX	Cat.6 FTP Patch Cord, Copper AWG 26/7, PVC, Length XXX m, Color XX
LW-CA6FH-XXX/XX	Cat.6 FTP Patch Cord, Copper AWG 26/7, LSZH, Length XXX m, Color XX
LW-CA6S-XXX/XX	Cat.6 SFTP Patch Cord, Copper AWG 28/7, PVC, Length XXX m, Color XX
LW-CA6SH-XXX/XX	Cat.6 SFTP Patch Cord, Copper AWG 28/7, LSZH, Length XXX m, Color XX

LW-CA6F-XXX/XX	x (1) Cable Length	0015=0.15m, 005=0.5m, 050=5m, 100=10m...
(1) (2)	xxx (2) Cable Color	BK=Black, WH=White, RD=Red, BL=Blue...

RJ45 Patch Cord, 10G Cat 6A S/FTP, PVC or LSZH

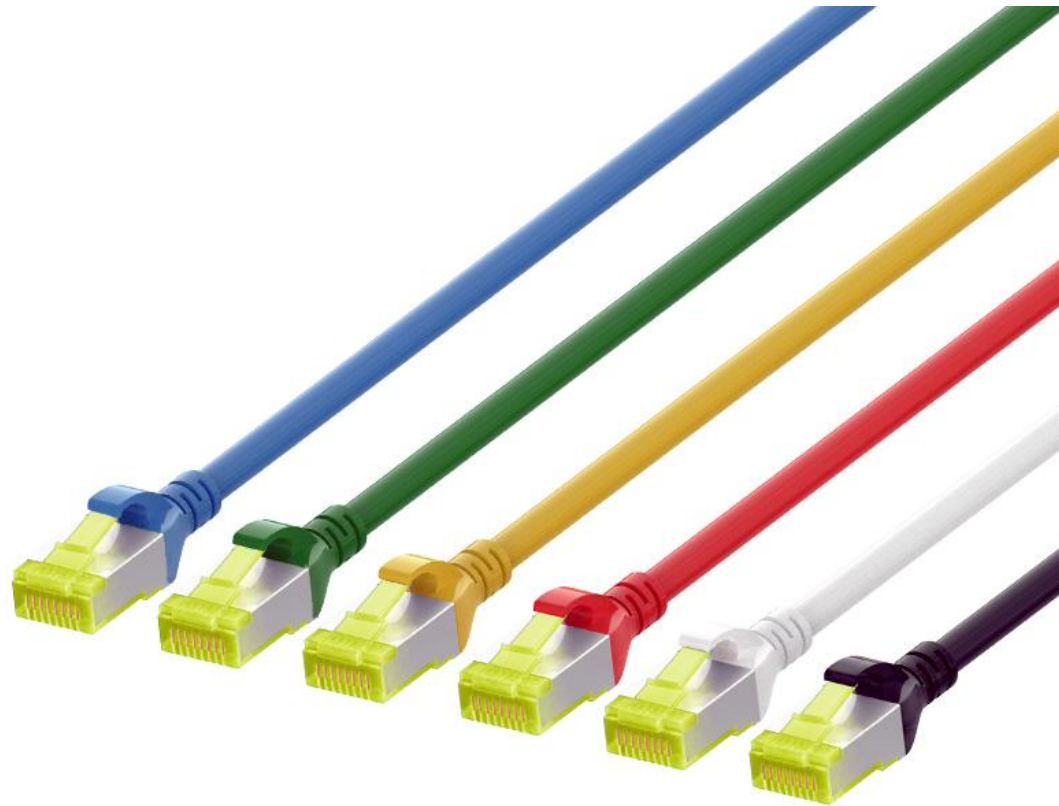

Features

- Cat 6A S/TP patch cord, TIA/EIA-568.D-2, ISO/IEC 11801-1 Class EA channel performance
- Bare copper wires, stranded
- S/FTP AWG 26//7, LSZH or PVC jacket, cable outer diameter is about 6.3mm
- IEC60512-99-002 POE type III 60W and IV 100W capability
- Different length, different cable colors are available
- CM, LSZH (IEC60332-1-2 / IEC 60332-3-24) and CM-LSZH dual rated jacket are available
- IEC60603-7 and IEC61935-2 dimensions and structural reliability complied
- Support 100/1000M Base-T, transmission up to 10 Gigabit 500MHz
- Molding type boot, different cable colors are available

Part Number	Description
LW-C6AS-XXX/XX	Cat.6A S/FTP Patch Cord, Copper AWG 26/7, PVC, Length XXX m, Color XX
LW-C6ASH-XXX/XX	Cat.6A S/FTP Patch Cord, Copper AWG 26/7, LSZH, Length XXX m, Color XX

LW-C6AS-XXX/XX

(1) (2)

x (1) Cable Length

xxx (2) Cable Color

0015=0.15m, 005=0.5m, 050=5m, 100=10m...

BK=Black, WH=White, RD=Red, BL=Blue...

RJ 45 Patch Cord, 10G Cat 7 S/ FTP, PVC or LSZH

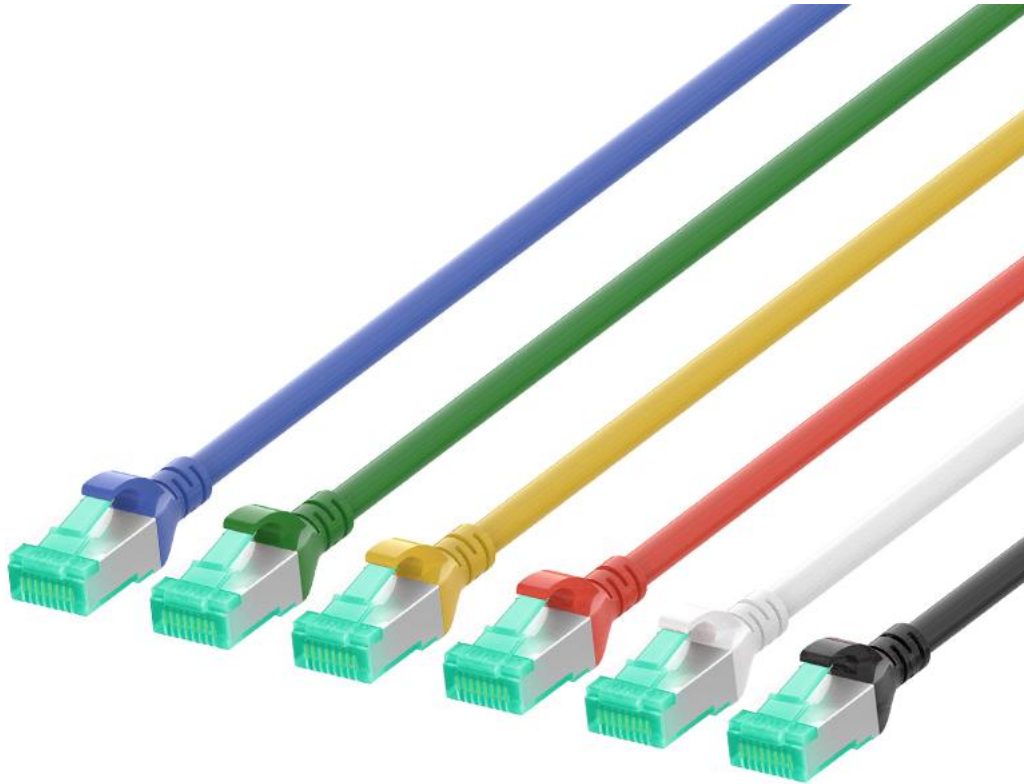

Features

- Cat 7 S/TP patch cord, TIA/EIA-568.D-2, ISO/IEC 11801-1 Class EA channel performance
- Bare copper wires, stranded
- S/FTP AWG 26//7, LSZH or PVC jacket, cable outer diameter is about 6.5mm
- IEC60512-99-002 POE type III 60W and IV 100W capability
- Different length, different cable colors are available
- CM, LSZH (IEC60332-1-2 / IEC 60332-3-24) and CM-LSZH dual rated jacket are available
- IEC60603-7 and IEC61935-2 dimensions and structural reliability complied
- Support 100/1000M Base-T, transmission up to 10 Gigabit 550MHz
- Molding type boot, different cable colors are available

Part Number	Description
LW-CA7S-XXX/XX	Cat.7 S/FTP Patch Cord, Copper AWG 26/7, PVC, Length XXX m, Color XX
LW-CA7SH-XXX/XX	Cat.7 S/FTP Patch Cord, Copper AWG 26/7, LSZH, Length XXX m, Color XX

LW-CA7S-XXX/XX	x (1) Cable Length	0015=0.15m, 005=0.5m, 050=5m, 100=10m...
(1) (2)	xxx (2) Cable Color	BK=Black, WH=White, RD=Red, BL=Blue...

RJ45 Patch Cord, Cat 8 S/FTP, PVC or LSZH

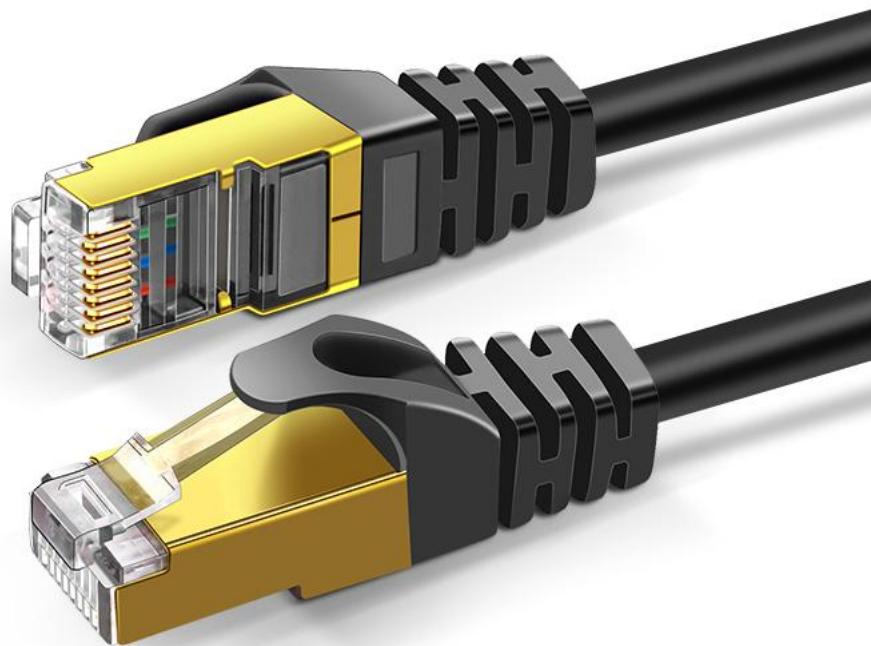

Features

- Cat 8 S/TP patch cord, TIA/EIA-568.D-2, ISO/IEC 11801-1 Class I channel performance
- Bare copper wires, stranded
- S/FTP AWG 26/7, LSZH or PVC jacket, cable outer diameter is about 6.5mm
- IEC60512-99-002 POE type III 60W and IV 100W capability
- Different length, different cable colors are available
- CM, LSZH (IEC60332-1-2 / IEC 60332-3-24) and CM-LSZH dual rated jacket are available
- IEC60603-7 and IEC61935-2 dimensions and structural reliability complied
- Support 100/1000M Base-T, transmission up to 40 Gigabit 2000MHz
- Molding type boot, different cable colors are available

Part Number	Description
LW-CA81S-XXX/XX	Cat.8 S/FTP Patch Cord, Copper AWG 26/7, PVC, Length XXX m, Color XX
LW-CA81SH-XXX/XX	Cat.8 S/FTP Patch Cord, Copper AWG 26/7, LSZH, Length XXX m, Color XX

LW-CA81S-XXX/XX

(1) (2)

x (1) Cable Length

xxx (2) Cable Color

0015=0.15m, 005=0.5m, 050=5m, 100=10m...

BK=Black, WH=White, RD=Red, BL=Blue...

Patch Panel, Full Shielded



Black (RAL9005)

Grey (RAL7035)



Features

- High headroom on Cat.5e/6/6A permanent link performance
- Full shielded sheet steel plate, electro-plated in black or grey color
- IEC60512-99-002 PoE type III 60W and IV 100W capability
- Power over HDBaseT (PoHDBaseT - up to 100W)
- Desk-top type patch panel is available to mount on the wall
- Smart lock design to save installer operating time and cost
- Accepts copper wire gauge 23AWG to 26AWG
- Works with standard 110 and Krone type punch down tools
- High quality connectors ensure system reliability and stability by automation line

Part No.	Description
LW-PAN8-CXSD/XX	STP Patch panel, 1U 8-Port, Desktop type (available in black or grey)
LW-PAN12-CXSD/XX	STP Patch panel, 1U 12-Port, Desktop type (available in black or grey)
LW-PAN24-CXS/XX	STP Patch panel, 1U 24-Port, 19 Rack Mount type (available in black or grey)

LW-PAN24-CXS/XX	x (1) Category	5=Cat.5e, 6=Cat.6, 6A=Cat.6A
(1) (2)	xxx (2) Color	BK=Black (RAL 9005), GY=Grey (RAL 7035)

Empty Patch Panel For Keystone Moudles



Part No.	Description
A LW-PAN24-LKY	19" 1U 24-Port Empty Patch Panel For Keystone, STP, With Label Field & Cable Management, Black
B LW-PAN12-LK	19" 1U 12-Port Empty Patch Panel For Keystone, STP, With Label Field & Cable Management, Black
C LW-PAN24-LK	19" 1U 24-Port Empty Patch Panel For Keystone, STP, With Label Field & Cable Management, Black

- * UTP blank panel is painted in black color, and not include grounding earth wire
- * STP blank panel keystone frame with Nickel plated, includes grounding earth wire

Empty Patch Panel, Full Shielded, Desk-Top Type Back Plate Available For Wall Mount



Features

- Desk-top type, back plate with wall mounting screw holes
- Full shielded sheet steel plate, electro-plated in black or grey color
- 1U 8-port layout and 12-port layout
- Suitable for standard RJ45 UTP/STP keystone jacks
- Suitable for multimedia keystone jacks (USB, HDMI, RCA,A/V keystone modules)
- Suitable for LC/SC keystone frame + fiber optic couplers
- Back plate designed with rotation type fixing knob for quick open and close the case
- Accessories including wall mount screws and cable ties
- With grounding earth wire

Part No.	Description
LW-BPP-8SD	STP Patch panel, 1U 8-Port, Desktop type (available in black or grey)
LW-BPPS-12SD	STP Patch panel, 1U 12-Port, Desktop type (available in black or grey)

*Back plate with hanging screw holes for wall mounting purpose

*Accessories including wall mount expansion screws

High-Density Blank Patch Panel 19 inch 1U 48-Port, UTP and STP

A



B

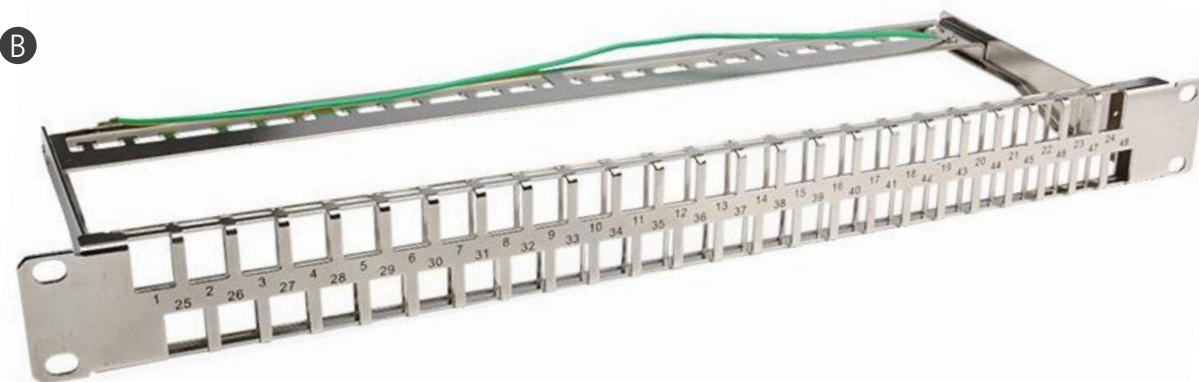

Part No.	Description
A LW-BPP-48U	19" 1U 48-Port High-Density Blank Patch Panel, UTP, Black
B LW-BPP-48U	19" 1U 48-Port High-Density Blank Patch Panel, STP, Silver (Nickel-Plated)

* UTP blank panel is painted in black color, and not include grounding earth wire

* STP blank panel keystone frame with Nickel plated, includes grounding earth wire

Blank Patch Panel, 19 inch 1U 24-Port, Rack Mount Front Panel With Large Label Field And Dust Cover Cable Management With Smart Cable Fixing Clips

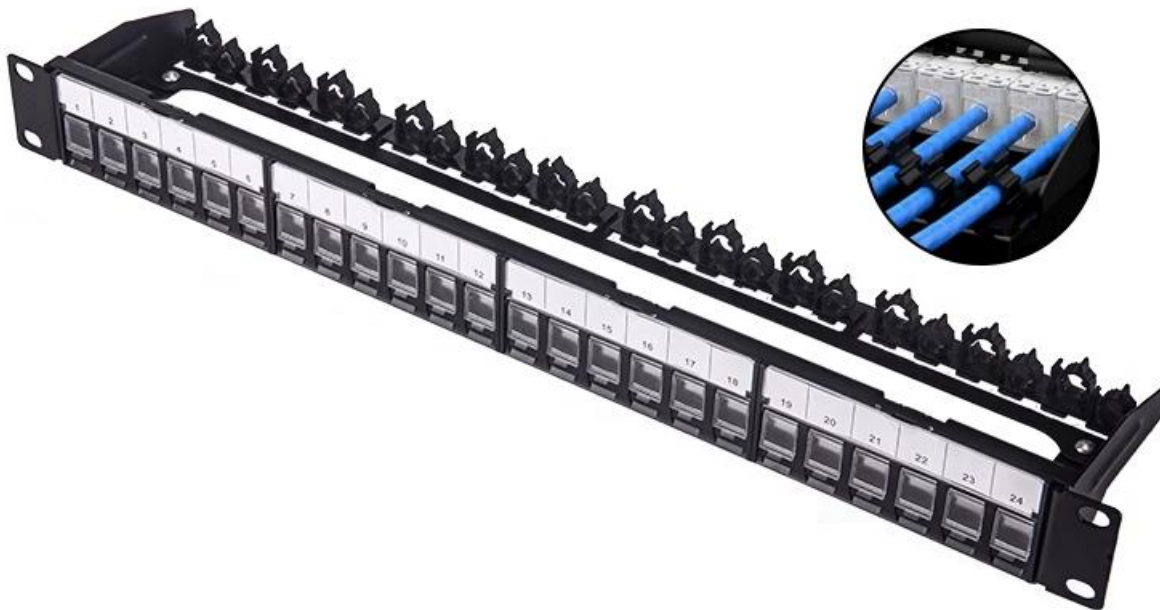

Features

- 19 inch 1U 24-port rack mount
- Sheet steel plate, electro-plated in black (UTP) or silver color (STP)
- 1U 24-port layout for standard keystone jacks
- Suitable for standard RJ45 UTP/STP keystone jacks
- Suitable for multimedia keystone jacks (USB, HDMI, RCA,AV keystone modules)
- Suitable for LC/SC keystone frame + fiber optic couplers
- Cable management bar designed with smart cable fixing clips
- Accessories including M6 screws for rack mount on cabinet
- STP version with grounding earth wire

Part No.	Description
LW-BP24U-DF	Blank Patch panel, 1U 24-Port, UTP, With Large Label Field & Smart Cable Clips
LW-BP24S-DF	Blank Patch panel, 1U 24-Port, STP, With Large Label Field & Smart Cable Clips

* UTP blank panel is painted in black color, and not include grounding earth wire

* STP blank panel keystone frame with Nickel plated, includes grounding earth wire

Blank Patch Panel, 19 inch 1U 24/48 Port UTP/STP, Foldable, Triangular Type



Features

- High-density angled panel eliminates need for horizontal managers, allowing patch cords to flow directly into vertical management
- Saving 60% room for stock, package and transportation
- Front panel is optional with solid steel or plastic panel

Part No.	Description	
A	LW-PAN-24VU LW-PAN-24VF	Package size L x W x H: 285 x 85 x 55mm Foldable 1U 24-Port keystone jack panel, UTP type, solid steel front panel Foldable 1U 24-Port keystone jack panel, FTP type, solid steel front panel
	B	LW-PAN-48VU LW-PAN-48VF

- * UTP blank panel is painted in black color, and not include grounding earth wire
- * STP blank panel keystone frame with Nickel plated, includes grounding earth wire

90° UTP ISDN Patch Panel, 1U-25/50 port



Standards Compliance

- ANSI/TIA-568.2-D Cat. 3
- ISO/IEC 11801-1, Class C
- IEC 60603-7
- IEEE 802.3af Type 1 PoE 15 W
- ANSI/TIA-1096-A (formerly FCC Part 68)
- UL1863
- RoHS/REACH compliant

Part Number Descriptions

Part Number	Descriptions
LW-PAN25-KD/XX	90° UTP ISDN Patch Panel, 1U-25port, Krone-110 dual IDC (Black or Grey Color)
LW-PAN50-KD/XX	90° UTP ISDN Patch Panel, 1U-50port, Krone-110 dual IDC (Black or Grey Color)

Cat.8 S/FTP 22AWG Solid Cable

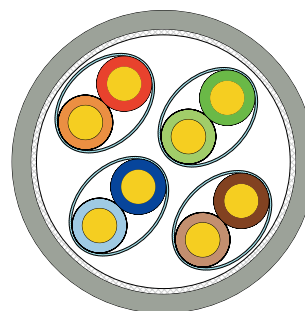

Features

- GHMT verified ISO/IEC 11801-1 Class I and EN50173-1 2-connector 30m channel performance up to 2GHz
- UL444 cable safety listed
- Power over HDBaseT™ (PoH) applications up to 100 W
- Construction Products Regulation (CPR) EuroClass Eca for LSZH jacket type

Standards Compliance

- ANSI/TIA-568.2-D
- ISO/IEC 11801-1 Class I
- EN50173-1
- UL 444 (for UL CM or CMR PVC jacket material only)
- UL 444-LP
- IEC 60332-1-2
- IEC 61034-2 smoke (for LSZH jacket material only)
- IEC 60754-2 halogen/acid (for LSZH jacket material only)
- RoHS/REACH compliant
- CPR Eca

Part Number

Descriptions

LW-CA8SH22-500/YL	Cat.8 S/FTP 22 AWG solid wires, IEC60332-1-2 LSZH, RAL5015 yellow color, 500 meters in wooden reel
LW-CA8SP22-500/YL	Cat.8 S/FTP 22 AWG solid wires, UL CM PVC, RAL5015 yellow color, 500 meters in wooden reel

LW-CA8SH22-500/YL
(1) (2) (3)

- | | | |
|-----|---------------------|---|
| x | (1) Jacket material | H=LSZH, P=PVC (UL CM) |
| xxx | (2) Packing | 100=100 meters in PE roll, 305=305 meters in wooden reel
500=500 meters in wooden reel |
| xx | (3) Jacket color | OR=Orange, BL=Blue, BK=Black, WH=White, YL=Yellow |

Packing Information

- 500 meters in a wooden reel
- Wooden reel size : D55 x H23cm
- Net weight per reel: 36 kg
- Gross weight per reel: 39 kg

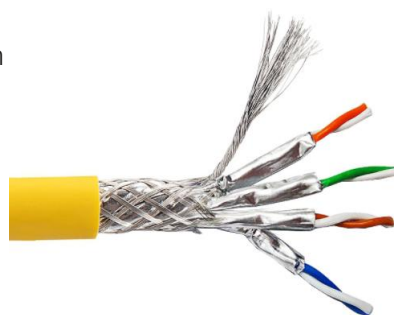

Cat.7 S/FTP 23AWG Solid Cable

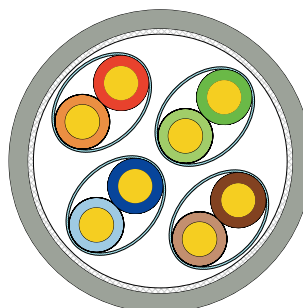

Features

- 3P lab. verified ISO/IEC11801-1, EN50173-1, IEC61156-5 and EN50288-4-1 Cat.7 100m cable performance
- UL444 cable safety listed
- Power over HDBaseT™ (PoH) applications up to 100 W
- Construction Products Regulation (CPR) EuroClass Eca

Standards Compliance

- ISO/IEC 11801-1
- EN 50173-1
- IEC 61156-5
- EN50288-4-1
- UL 444 (for UL CM or CMR PVC jacket material only)
- UL 444-LP
- IEC 60332-1-2 or IEC 60332-3-24 fire retardant
- IEC 61034-2 smoke (for LSZH jacket material only)
- IEC 60754-2 halogen/acid (for LSZH jacket material only)
- RoHS/REACH compliant
- CPR Eca

Part Number

Descriptions

- LW-CA7SH-500/OR Cat.7 S/FTP 23 AWG solid wires, IEC60332-1-2 LSZH, Orange color, 500 meters in wooden reel
- LW-CA7SP-500/OR Cat.7 S/FTP 23 AWG solid wires, UL CM PVC, Orange color, 500 meters in wooden reel

LW-CA7SH-500/OR (1) (2) (3)	x	(1) Jacket material	H=LSZH, P=PVC (UL CM)
	xxx	(2) Packing	100=100 meters in PE roll, 305=305 meters in wooden reel 500=500 meters in wooden reel
	xx	(3) Jacket color	OR=Orange, BL=Blue, BK=Black, WH=White, YL=Yellow

Packing Information

- 500 meters in a wooden reel
- Wooden reel size : D49 x H22cm
- Net weight per reel: 25 kg
- Gross weight per reel: 28 kg



Cat.6A S/FTP 23AWG Solid Cable

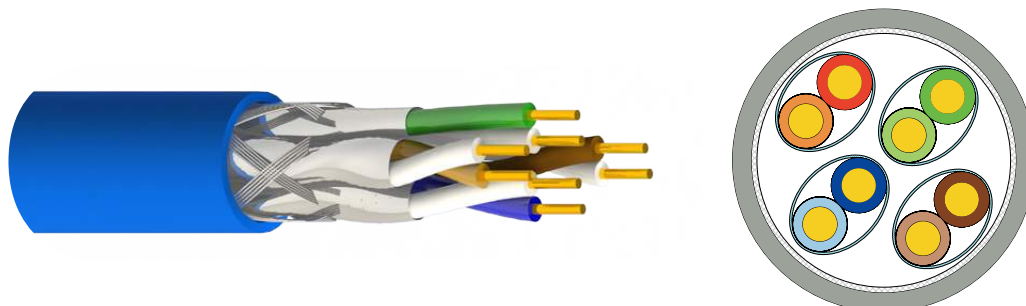

Features

- 3P lab. verified ISO/IEC11801-1, EN50173-1, ANSI/TIA-568.2-D, IEC61156-5 and EN50288-10-1 Cat.6A 100m cable performance
- UL444 cable safety listed
- Power over HDBaseT™ (PoH) applications up to 100 W
- Construction Products Regulation (CPR) EuroClass Eca

Standards Compliance

- ISO/IEC 11801-1
- EN 50173-1
- ANSI/TIA-568.2-D
- IEC 61156-5
- EN50288-10-1
- CPR Eca
- UL 444 (for UL CM or CMR PVC jacket material only)
- UL 444-LP
- IEC 60332-1-2 or IEC 60332-3-24 fire retardant
- IEC 61034-2 smoke (for LSZH jacket material only)
- IEC 60754-2 halogen/acid (for LSZH jacket material only)
- RoHS/REACH compliant

Part Number

LW-C6ASH-500/BL

LW-C6ASP-500/BL

Descriptions

Cat.6A S/FTP 23 AWG solid wires, IEC60332-1-2 LSZH, Blue color, 500 meters in wooden reel

Cat.6A S/FTP 23 AWG solid wires, UL CM PVC, Blue color, 500 meters in wooden reel

LW-C6ASH-500/BL (1) (2) (3)	x	(1) Jacket material	H=LSZH, P=PVC (UL CM)
	xxx	(2) Packing	100=100 meters in PE roll, 305=305 meters in wooden reel 500=500 meters in wooden reel
	xx	(3) Jacket color	OR=Orange, BL=Blue, BK=Black, WH=White, YL=Yellow

Packing Information

- 500 meters in a wooden reel
- Wooden reel size : D49 x H22cm
- Net weight per reel: 25 kg
- Gross weight per reel: 28 kg

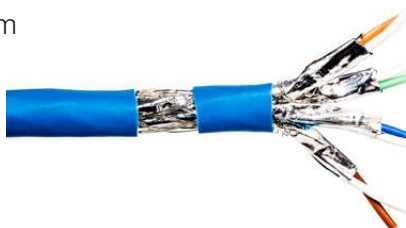

Cat.6A U/UTP 23AWG Solid Cable

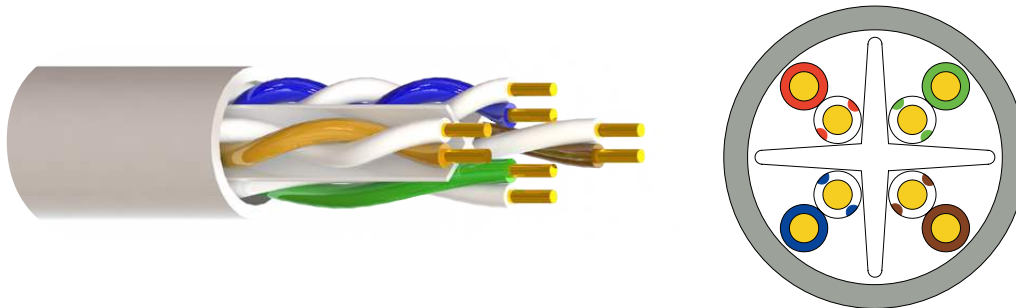

Features

- Real U/UTP cable structure without any metallic shield design
- ETL verified ANSI/TIA-568.2-D, ISO/IEC11801-1 and IEC61156-5 100m cable included the Cat.6A Alien-Cross-Talk performance
- UL444 cable safety listed
- Power over HDBaseT™ (PoH) applications up to 100 W

Standards Compliance

- ANSI/TIA-568.2-D
- ISO/IEC 11801-1
- IEC 61156-5
- UL 444 (for UL CMR PVC jacket material only)
- UL 444-LP
- IEC 60332-1-2
- IEC 61034-2 smoke (for LSZH jacket material only)
- IEC 60754-2 halogen/acid (for LSZH jacket material only)
- RoHS/REACH compliant

Part Number

Descriptions

- LW-C6AUH-305/GY Cat.6A UTP 23 AWG solid wires, IEC60332-1-2 LSZH, Grey color, 305 meters in wooden reel
- LW-C6AUP-305/GY Cat.6A UTP 23 AWG solid wires, UL CM PVC, Grey color, 305 meters in wooden reel

LW-C6AUH-305/GY (1) (2) (3)	x	(1) Jacket material	H=LSZH, P=PVC (UL CM)
	xxx	(2) Packing	100=100 meters in PE roll, 305=305 meters in wooden reel 500=500 meters in wooden reel
	xx	(3) Jacket color	GY=Grey, BL=Blue, BK=Black, WH=White, RD=Red

Packing Information

- 305 meters in a wooden reel
- Wooden reel size : D40 x H30cm
- Net weight per reel: 17.5 kg
- Gross weight per reel: 19.5 kg

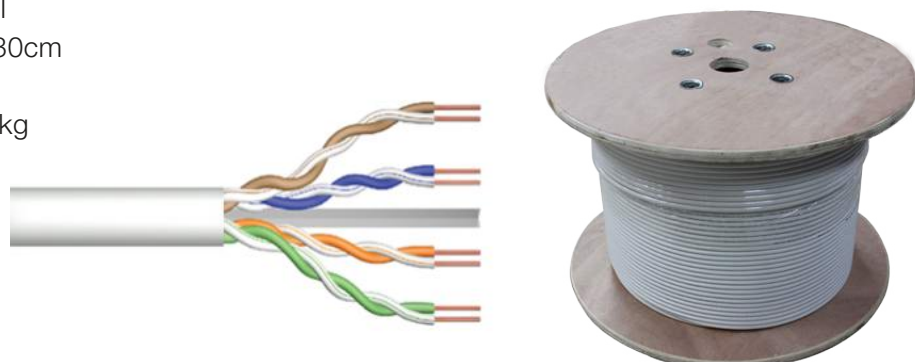

Cat.6 U/UTP 23AWG Solid Cable

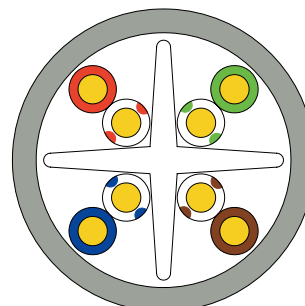

Features

- ETL verified ANSI/TIA 568.2-D Cat.6 100m cable performance up to 250MHz
- UL444 cable safety listed
- Power over HDBaseT™ (PoH) applications up to 100 W
- Construction Products Regulation (CPR) EuroClass Eca

Standards Compliance

- ANSI/TIA-568.2-D
- ISO/IEC 11801-1
- IEC 61156-5
- UL 444 (for UL CMR PVC jacket material only)
- UL 444-LP
- IEC 60332-1-2
- IEC 61034-2 smoke (for LSZH jacket material only)
- IEC 60754-2 halogen/acid (for LSZH jacket material only)
- RoHS/REACH compliant
- CPR Eca

Part Number

Descriptions

LW-CA6UH-305/GY	Cat.6 UTP 23 AWG solid wires, IEC60332-1-2 LSZH, Grey color, 305 meters in easy pull-box
LW-CA6UP-305/GY	Cat.6 UTP 23 AWG solid wires, UL CM PVC, Grey color, 305 meters in easy pull-box

LW-CA6UH-305/GY (1) (2) (3)	x	(1) Jacket material	H=LSZH, P=PVC (UL CM)
	xxx	(2) Packing	100=100 meters in PE roll, 305=305 meters in easy pull-box 500=500 meters in wooden reel
	xx	(3) Jacket color	GY=Grey, BL=Blue, BK=Black, WH=White, RD=Red

Packing Information

- 305m in a easy pull-box
- Easy neutral box size : L40 x W40 x H21cm
- Net weight per neutral easy box: 11.5 kg
- Gross weight per neutral easy box: 12.5 kg

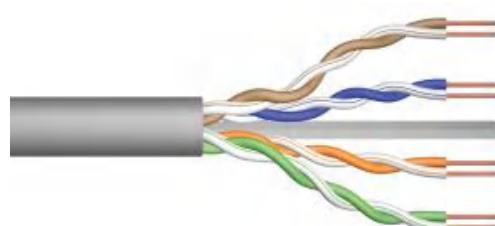

Cat.6 U/UTP 24AWG Solid Cable

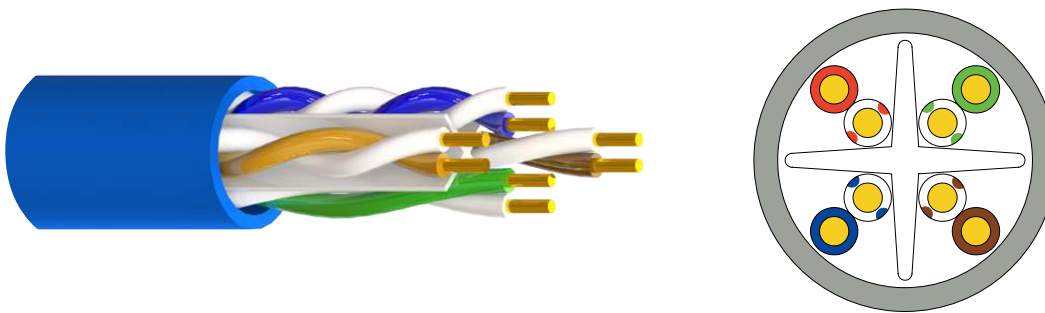

Features

- Slim O.D. and compact Pull-Box size for economic shipping cost
- Big cable Pull-Out tube
- Compliant with ANSI/TIA 568.2-D Cat.6 performance up to 250MHz
- UL444 cable safety listed
- Power over HDBaseT™ (PoH) applications up to 100 W
- Construction Products Regulation (CPR) EuroClass Eca

Standards Compliance

- ANSI/TIA-568.2-D
- ISO/IEC 11801-1
- IEC 61156-5
- UL 444 (for UL CMR PVC jacket material only)
- UL 444-LP
- IEC 60332-1-2
- IEC 61034-2 smoke (for LSZH jacket material only)
- IEC 60754-2 halogen/acid (for LSZH jacket material only)
- RoHS/REACH compliant
- CPR Eca

Part Number Descriptions

LW-CA64UH-305/GY	Cat.6 UTP 24 AWG solid wires, IEC60332-1-2 LSZH, Grey color, 305 meters in easy pull-box
LW-CA64UP-305/GY	Cat.6 UTP 24 AWG solid wires, UL CM PVC, Grey color, 305 meters in easy pull-box

LW-CA64UH-305/GY	x	(1) Jacket material	H=LSZH, P=PVC (UL CM)
(1) (2) (3)	xxx	(2) Packing	100=100 meters in PE roll, 305=305 meters in easy pull-box 500=500 meters in wooden reel
	xx	(3) Jacket color	GY=Grey, BL=Blue, BK=Black, WH=White, RD=Red

Packing Information

- 305m in a easy pull-box
- Easy neutral box size : L40 x W40 x H21cm
- Net weight per neutral easy box: 11.0 kg
- Gross weight per neutral easy box: 12.0 kg

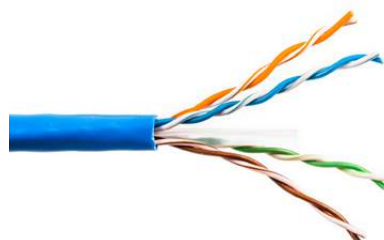

Cat.6&6A S/FTP 26AWG Stranded Cable

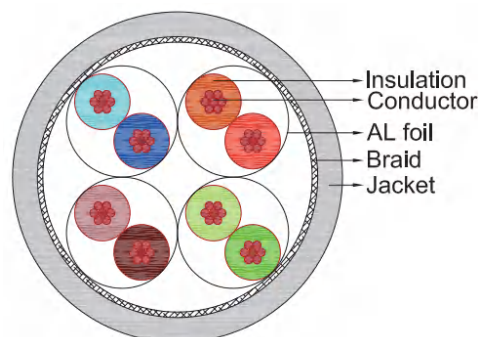

Features

- ETL verified ANSI/TIA 568.2-D Cat.6 100m cable performance up to 250MHz, Cat.6A up to 10G 500MHz
- UL444 cable safety listed
- Power over HDBaseT™ (PoH) applications up to 100 W
- Construction Products Regulation (CPR) EuroClass Eca

Standards Compliance

- ANSI/TIA-568.2-D
- ISO/IEC 11801-1
- IEC 61156-5
- UL 444 (for UL CMR PVC jacket material only)
- UL 444-LP
- IEC 60332-1-2
- IEC 61034-2 smoke (for LSZH jacket material only)
- IEC 60754-2 halogen/acid (for LSZH jacket material only)
- RoHS/REACH compliant
- CPR Eca

Part Number

Descriptions

LW-CA6SH-305-GY	Cat.6 S/FTP 26 AWG stranded wires, IEC60332-1-2 LSZH, Grey color, 305 meters in easy pull-box
LW-CA6SP-305-GY	Cat.6 S/FTP 26 AWG stranded wires, UL CM PVC, Grey color, 305 meters in easy pull-box
LW-C6ASH-305-GY	Cat.6A S/FTP 26 AWG stranded wires, IEC60332-1-2 LSZH, Grey color, 305 meters in easy pull-box
LW-C6ASP-305-GY	Cat.6A S/FTP 26 AWG stranded wires, UL CM PVC, Grey color, 305 meters in easy pull-box

LW-CA6UH-305/GY
(1) (2) (3)

x	(1) Jacket material	H=LSZH, P=PVC (UL CM)
xxx	(2) Packing	100=100 meters in PE roll, 305=305 meters in pull-box 500=500 meters in wooden reel
xx	(3) Jacket color	GY=Grey, BL=Blue, BK=Black, WH=White, RD=Red

Packing Information

- 305m in a easy pull-box
- Easy neutral box size : L40 x W40 x H21cm
- Net weight per neutral easy box: 11.5 kg
- Gross weight per neutral easy box: 12.5 kg



Copper Trunk
10G High Density
Plug and Play

MTP® Micro Cable



联威通讯有限公司（香港）
Linkway Communication Limited
Room 1318-20, Hollywood Plaza
610 Nathan Road, Mongkok
Kwloon, Hong Kong
www.linkwylan.com | info@hklinkway.com

东莞市联威通讯有限公司（大陆）
Dongguan Lianwei Communication Co.,Ltd
广东省东莞市松山湖园区怡乐路1号3栋310
310, Bldg #3, No.1 Yile Road, Songshan Lake Park
Dongguan City, Guangdong Province, China 523808
www.linkwylan.com | info@linkwylan.com